

INTRODUCING *Active Courses*

These 8 new active courses are designed with climbers, bridges, and overhead components that encourage physical fitness while having fun.

PS5-71357 \$51,553

Age Group: 5-12 Years

Capacity: 25-30

Structure Size: 31' x 27'

Use Zone: 43' x 39'

Fall Height: 10'

Est. Timber Count: 38

PS5-71363 \$34,145

Age Group: 5-12 Years

Capacity: 30-35

Structure Size: 35' x 35'

Use Zone: 47' x 47'

Fall Height: 11'

Est. Timber Count: 43

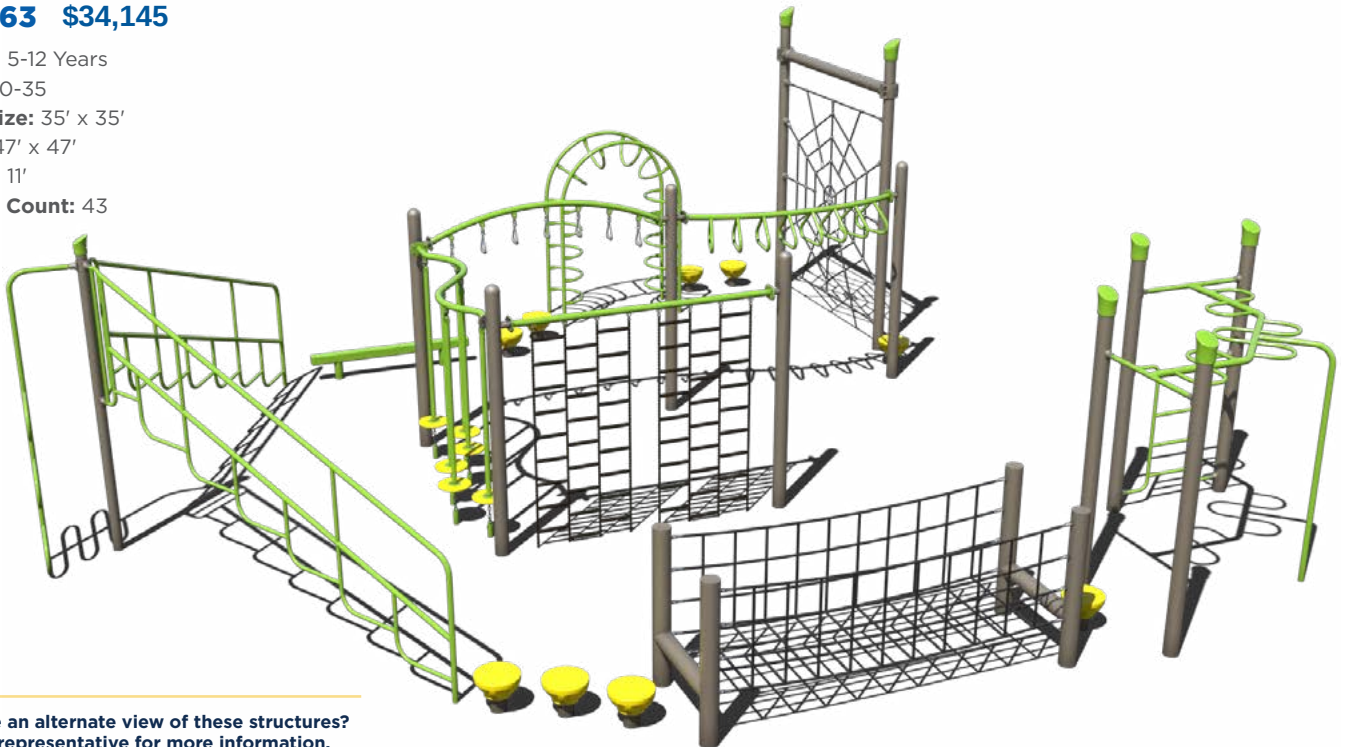

Want to see an alternate view of these structures?
Ask your representative for more information.

PS5-71361 \$91,314

Age Group: 5-12 Years
Capacity: 30-35
Structure Size: 28' x 43'
Use Zone: 40' x 55'
Fall Height: 7'
Est. Timber Count: 45



PS5-71362 \$66,224

Age Group: 5-12 Years
Capacity: 30-35
Structure Size: 58' x 25'
Use Zone: 70' x 37'
Fall Height: 10'
Est. Timber Count: 58



PS5-71364 \$40,936

Age Group: 5-12 Years
Capacity: 25-30
Structure Size: 26' x 36'
Use Zone: 38' x 48'
Fall Height: 7'
Est. Timber Count: 40

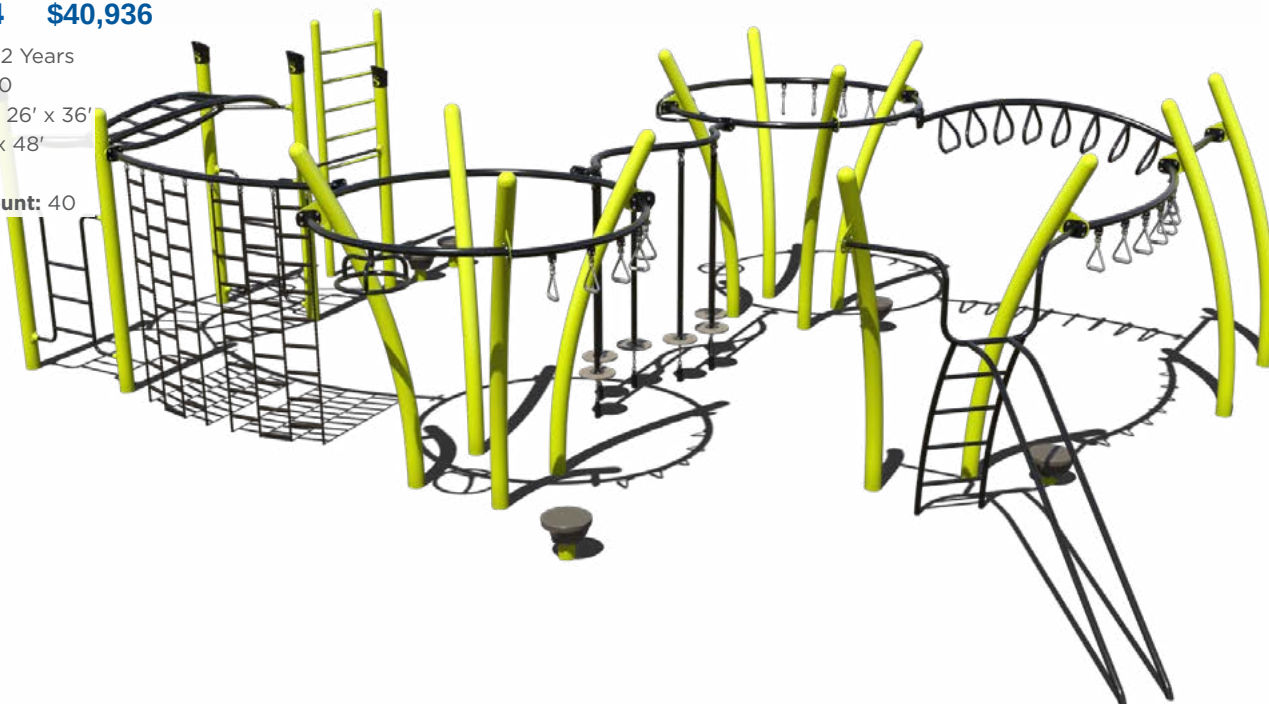

PS5-71366 \$64,805

Age Group: 5-12 Years
Capacity: 30-35
Structure Size: 40' x 37'
Use Zone: 52' x 49'
Fall Height: #'
Est. Timber Count: 58



PS5-71365 \$34,145

Age Group: 5-12 Years
Capacity: 20-25
Structure Size: 39' x 13'
Use Zone: 51' x 25'
Fall Height: 7'
Est. Timber Count: 35



PS5-71367 \$68,637

Age Group: 5-12 Years
Capacity: 30-35
Structure Size: 36' x 40'
Use Zone: 48' x 52'
Fall Height: 7'
Est. Timber Count: 46

