

# Site Amenities

BY SUPERIOR RECREATIONAL PRODUCTS

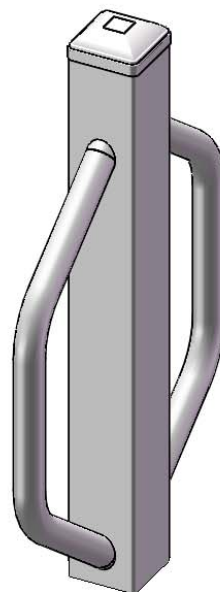

Model #  
BIKEPOST-ING

 **SUPERIOR**<sup>®</sup>  
RECREATIONAL PRODUCTS  
A **PLAYCORE** Company

# PRODUCT SPECIFICATIONS

## BIKEPOST-ING

Material: Post is constructed of 4" square steel tubing.

Coating: TGIC Electrostatic powder coated application oven cured

Dimensions of bollard shall be 36" high x 21-3/4" x 4".

# FOOTINGS

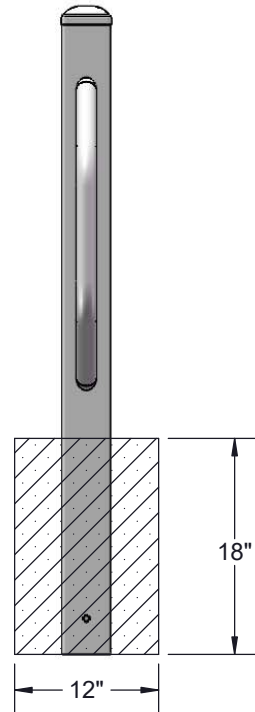
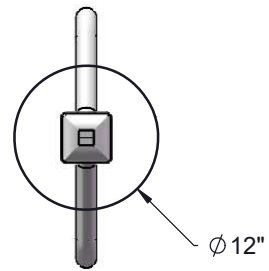

Estimated Required Concrete:  
4 - 50lb Bags of Concrete Mix

# OVERALL DIMENSIONS

