

USER GROUP: 2-5 Years, 5-12 Years

RECOMMENDED CREW: 2-3 People

TOOLS REQUIRED:

- TT-45 Torx, 9/16" Hex, 3/4" Hex, Phillips Drive
- Level, Square, Hammer / Mallet
- Auger / Post Hole Digger / Shovel
- Drill Bits: None
- Framing, Bracing, or Concrete Forms (Not Included)
- Ratchet Strap, Rope, Banding (Not Included)
- High Speed 3/8" Electric Drill with Clutch

NOTE: Use of any other driver may result in damage to product, tool, and/or hardware!

NOTE: Apply Thread Locking Solution to ALL Non-Patched Hardware with Threads!

INSTALLATION TIME: 4 Hours

WEIGHT: 392 lbs.

CONCRETE REQUIRED: 6.0 ft³ or 11.5 ft³

(See Page 4 and Page 5)

NOTE: Concrete must have a minimum rating of 2,500 psi and must be mixed per manufacturer's recommendations.

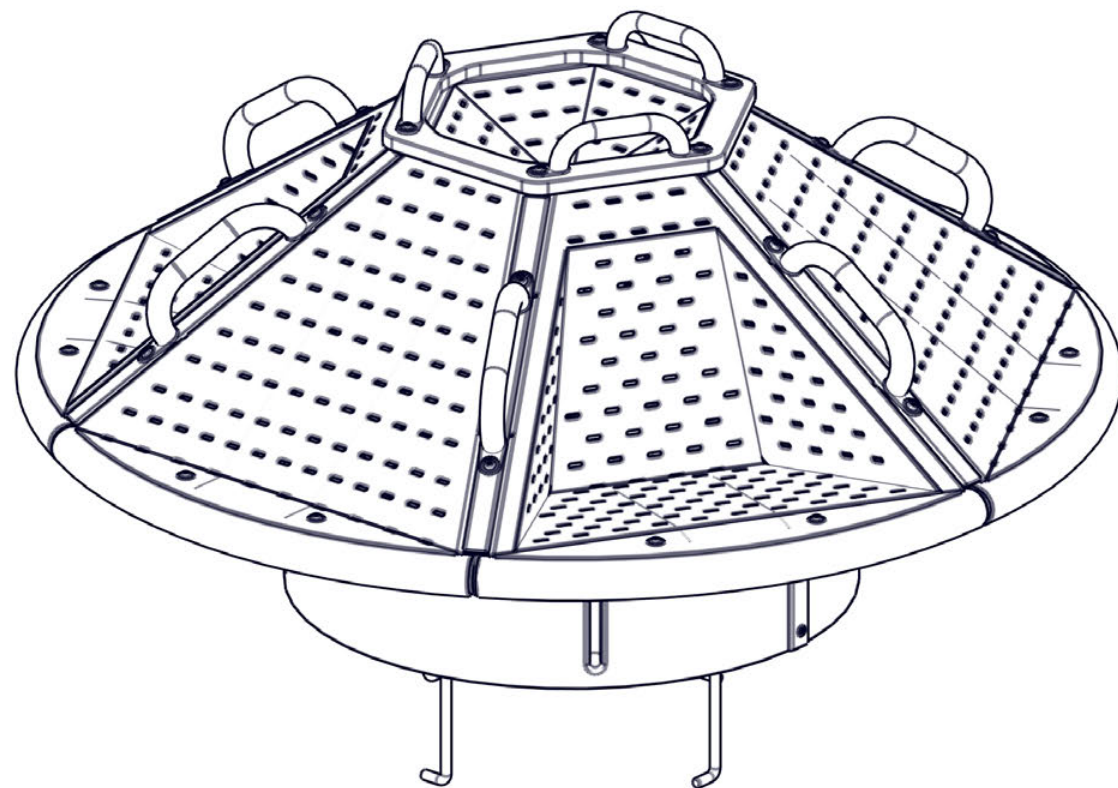

PRE-INSTALLATION CHECK:

Customer is responsible for verifying materials received by comparing received items with packing list. If any parts are missing or damaged, including documentation, contact your local sales representative immediately.

Supplier is not responsible for items discovered missing after 72 hours from time of delivery.

Before beginning installation, all installers must read and understand the Installation Introduction manual as supplied. If you did not receive a copy, or if you have any questions regarding any information in the Installation Instructions or this Installation Guideline, contact your local sales representative.

ITEM	Part No.	QTY	DESCRIPTION
1	127731	1	Base Assembly with Brake
2	124511	4	Shield Mounting Bracket
3	AFB-36033XX	1	Weldment - Merry Go Round Support Stand (Coated)
4	127322	2	Whirl Brake Cover
5	PLT-5661XX	1	Plate - Merry Go Round Cover Plate
6	AFB-36032XX	6	Weldment - Merry Go Round Outer Support Frame (Coated)
7	AFB-36421XX	6	Weldment - Merry Go Round Arm Dish Frame (Coated)
8	AFB-42978XX	3	Merry Go Round Platform (PVC Coated)
9	AFB-43088XX	3	Weldment - Inclusive Merry Go Round Flat Seat
10	RSP-6593XX	1	Sheet - Merry Go Round Guard Panel
11	AFB-43097XX	2	Inclusive Merry Go Round Dish Half (PVC Coated)
12	BKT-0275XX	3	BKT - Merry Go Round Guard (Coated)
13	AFB-36005XX	6	Weldment - Merry Go Round Grip (Coated)
14	AFB-36413XX	3	Weldment - Merry Go Round Dish Grip (Coated)
15	816017	4	#10 x 5/8" Pan Head Phillips Screw
16	817408	4	1/4" Flat Washer (5/8" O.D.)
17	801850	4	3/8" x 1" Self-Tapping Hex Head Bolt
18	HWB0249	12	Bolt 3/8"- x 3-3/4" TORX Security with Patch
19	HWB0210	22	Bolt 3/8"-16 x 1" TORX Security with Patch
20	HWB0286	36	Bolt 3/8"-16 x 1-1/4" TORX Security with Patch
21	HWB0233	6	Bolt 3/8"-16 x 2-1/2" TORX Security with Patch
22	HWWR0075	146	Washer 3/8" ID x 1" OD Flat - 300 Series SS
23	HWN0098	70	Nut 3/8"- Nylock 300 S/S
24	801003	24	3/8"-16 x 1" Zinc Hex Head Bolt
25	801004	4	3/8" x 1 1/4" Hex Head Bolt
26	817334	28	3/8" Lock Washer
27	817424	28	3/8" Flat Washer (1 1/4" O.D)
28	804053	4	3/8" Hex Nut
29	800000	4	1/2" Anchor Bolt
30	817342	4	Washer - 1/2" Lockwasher SS
31	804055	8	Nut - 1/2" Hex SS

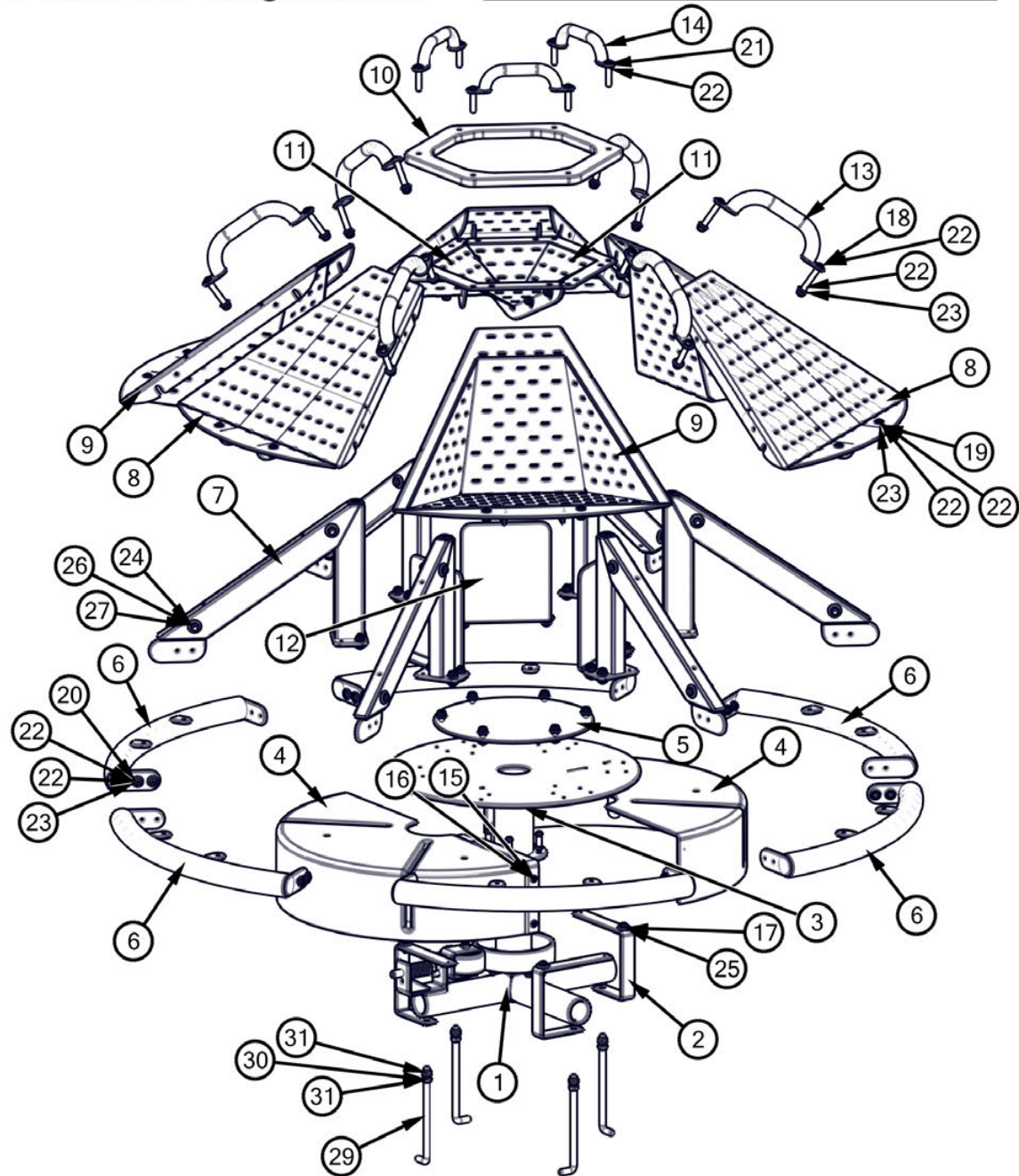

STEP 1

Speed brake **MUST BE ADJUSTED** after unit is fully assembled and before use. Minimum use zone is 72". For use zones less than 108", maximum speed should be set to 32 RPM (rounds per minute). For use zones greater than 108", maximum speed should be set to 45 RPM. See STEP 14 for speed brake adjustment.

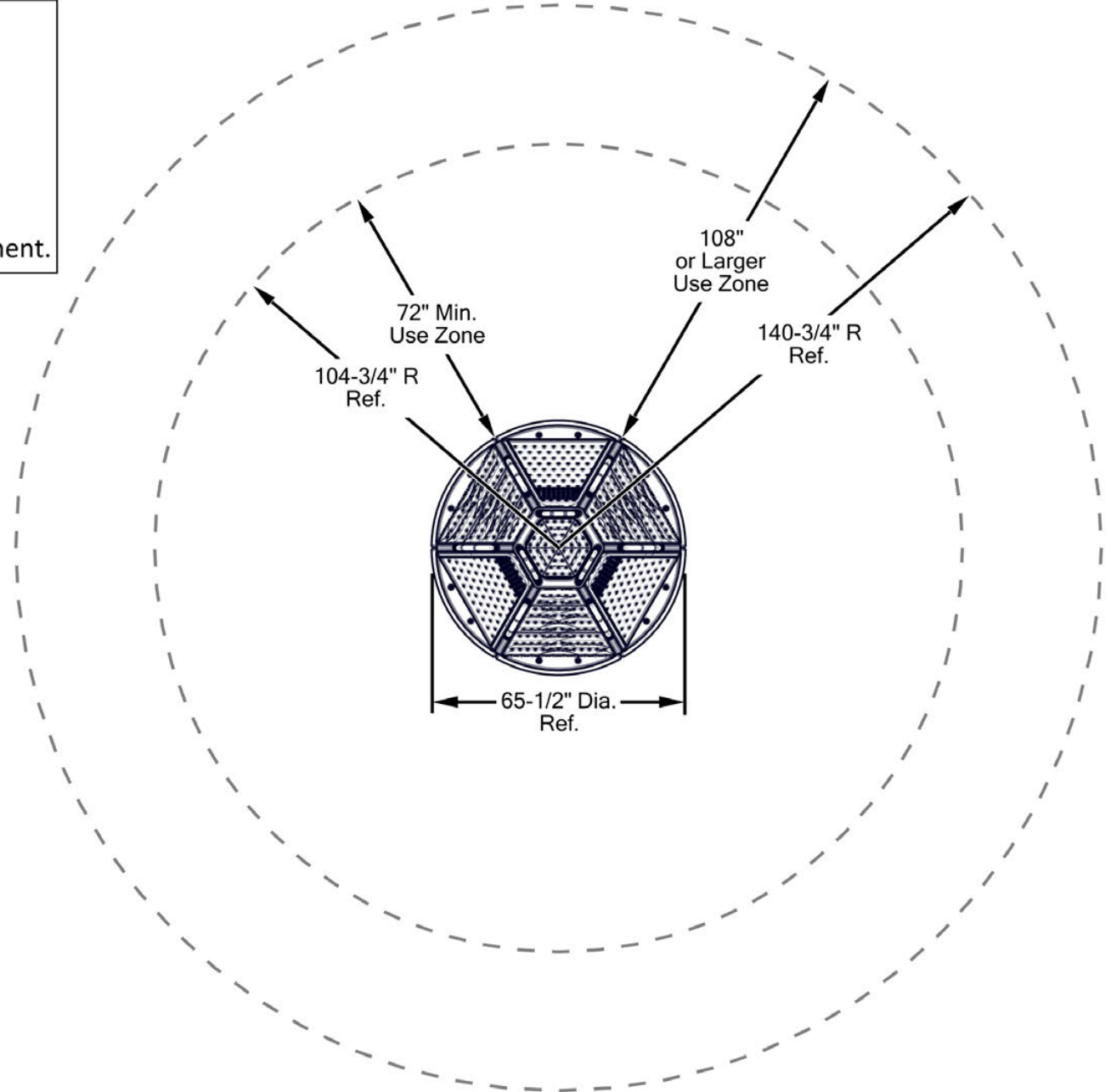

STEP 2

Mount shield mounting brackets and anchor bolts to base assembly with brake. For four (4) 1/2" anchor bolts, screw one (1) 1/2" hex nut onto anchor bolt 3/4" from end of anchor bolt. Align holes in brackets with holes in arm of base assembly. Insert one (1) anchor bolt with nut through bracket and base arm. Secure with one (1) 1/2" lock washer and one (1) 1/2" hex nut. See Detail 2-1. Repeat for all anchor bolt, brackets, and base arms.

Detail 2-1

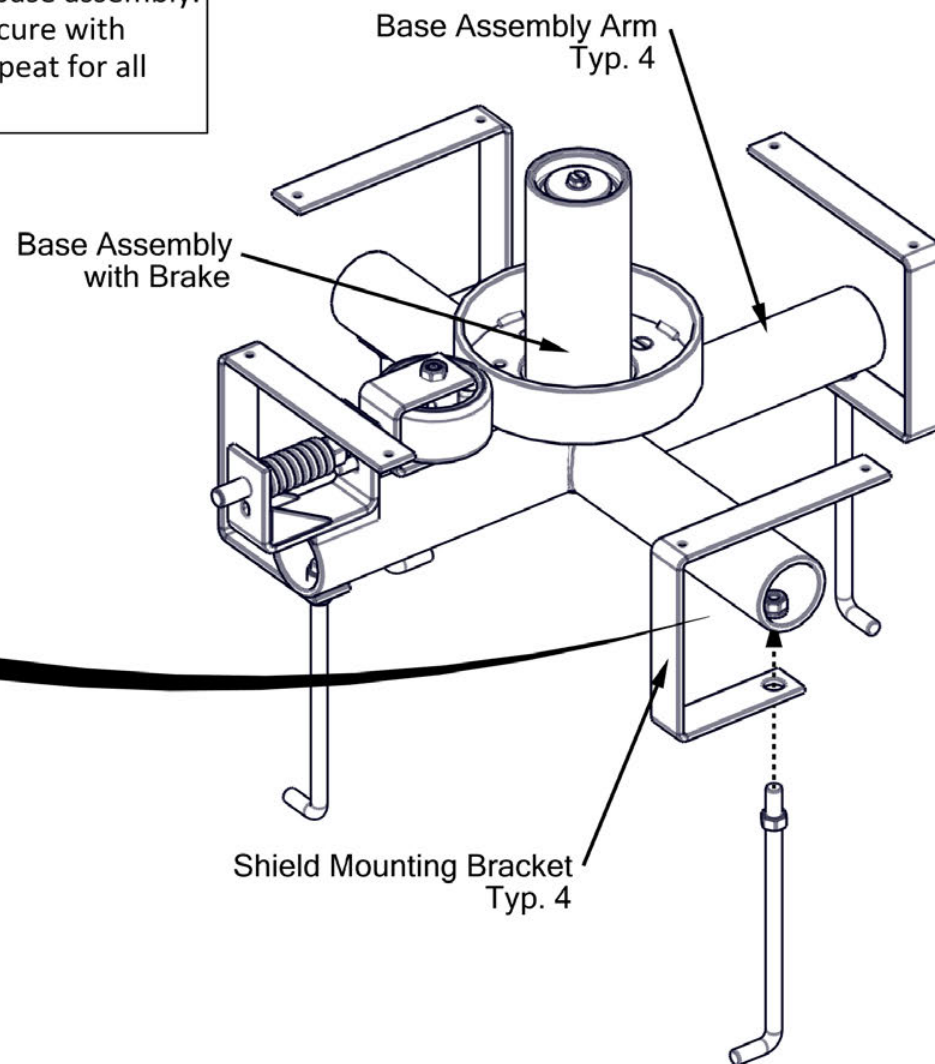
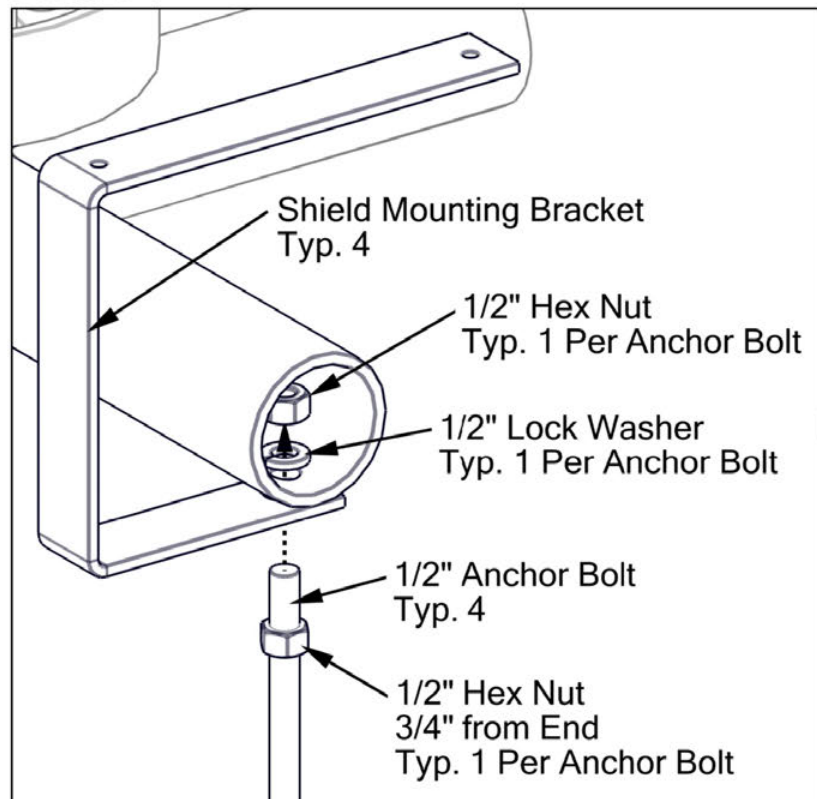

STEP 3

(Concrete Partially Above SubGrade)

Excavate footing hole. Hole size should be 30" x 30". Footing depth is determined by site conditions and surfacing. Use concrete forms (not included) as needed. Fill footing hole with concrete to 2" below finished surfacing. Place base assembly onto top of concrete. Insert anchor bolts into concrete. Unless concrete has partially cured, bracing (not included) may be required. Ensure shield mounting brackets are level. Ensure center shaft plumb. Allow concrete to FULLY CURE based upon manufacturer's instructions BEFORE proceeding to STEP 4.

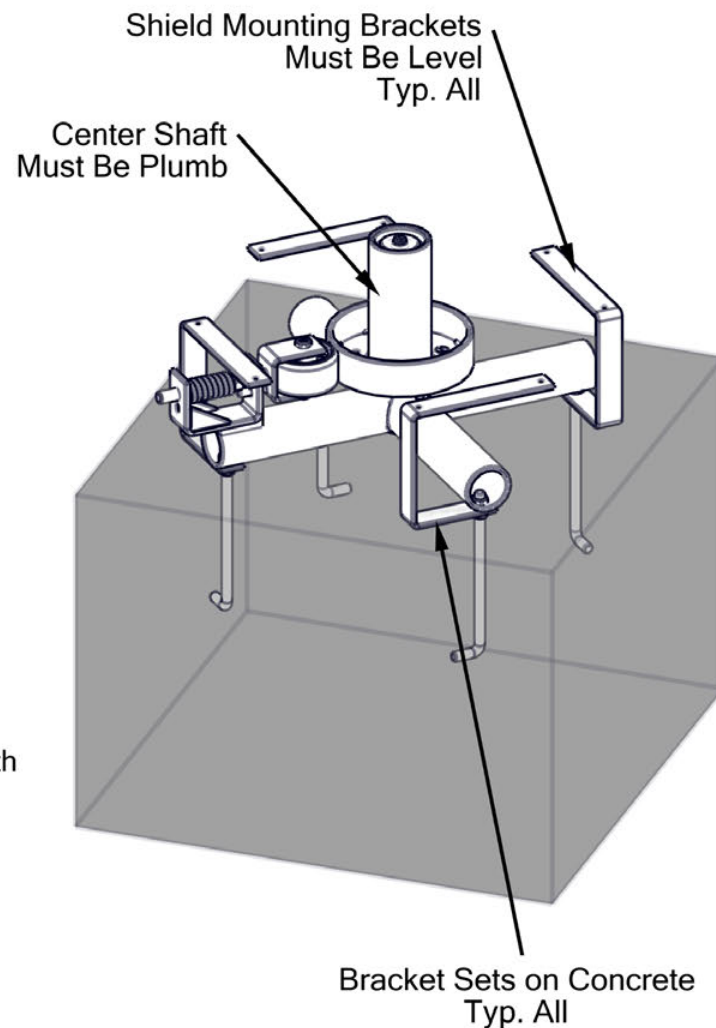
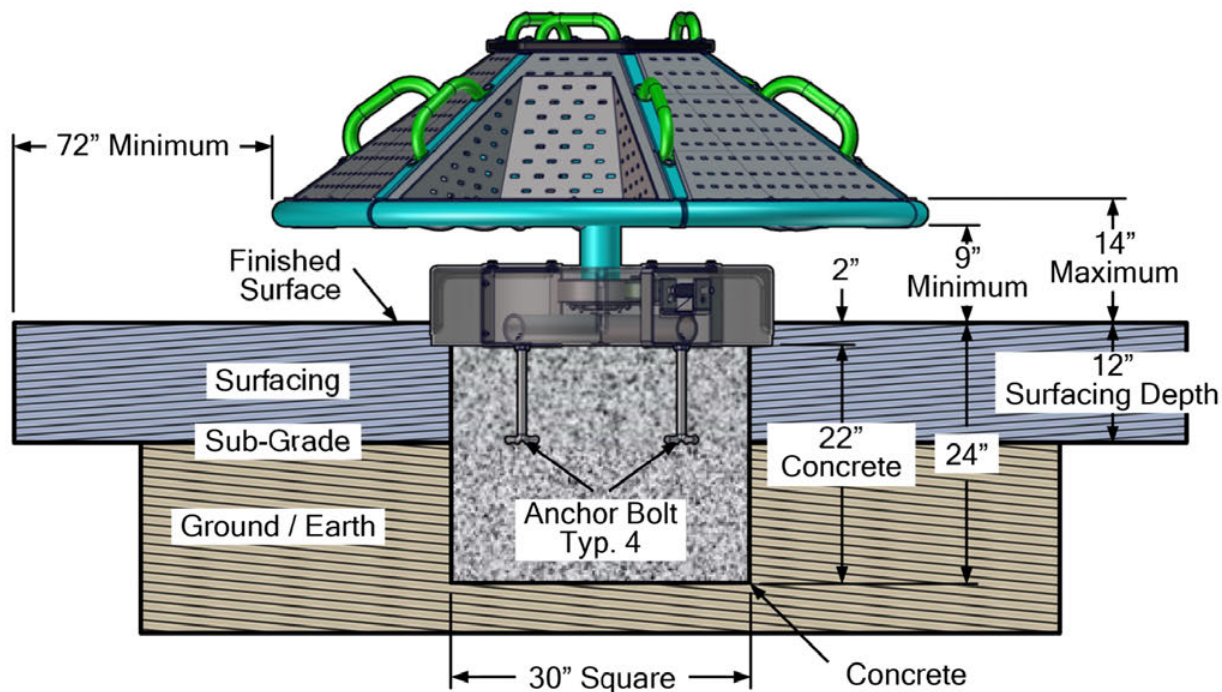

Concrete Forms and Framing Provided by Installer

Allow Concrete to Cure Based Upon Manufacturer's Specifications. Recommended Cure Time is 7 Days.

Concrete Required: 11.5 ft³ - 0.42 cubic yards

STEP 3

(Concrete Fully Below SubGrade)

Excavate footing hole. Hole size should be 24" x 24". Footing depth is determined by site conditions and surfacing. Use concrete forms (not included) as needed. Fill footing hole with concrete to 2" below finished surfacing. Place base assembly onto top of concrete. Insert anchor bolts into concrete. Unless concrete has partially cured, bracing (not included) may be required. Ensure shield mounting brackets are level. Ensure center shaft plumb. Allow concrete to FULLY CURE based upon manufacturer's instructions BEFORE proceeding to STEP 4.

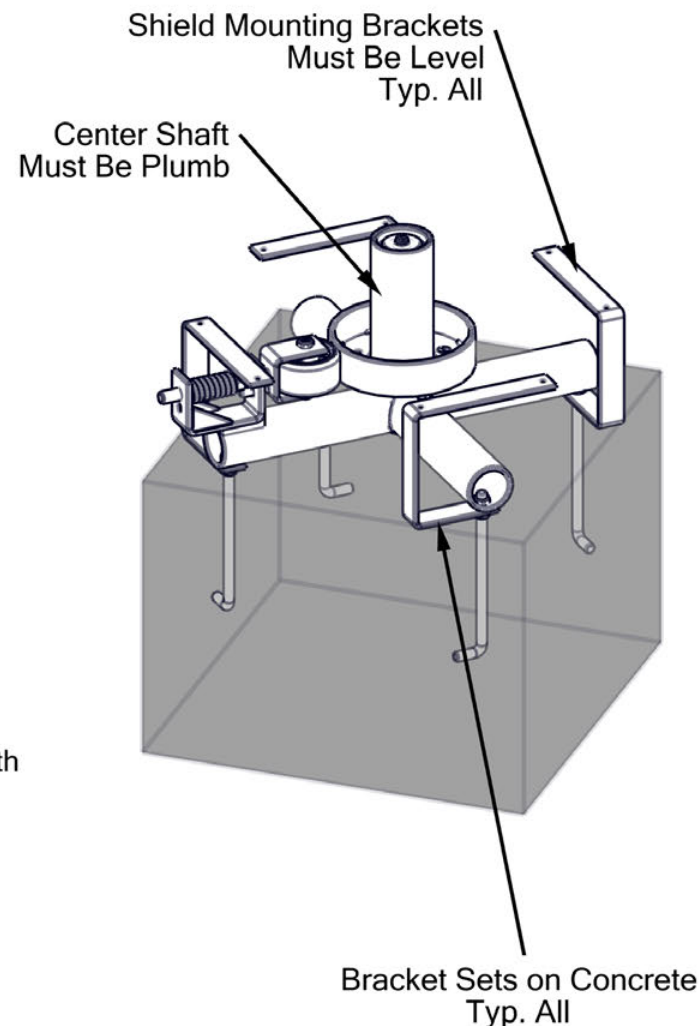
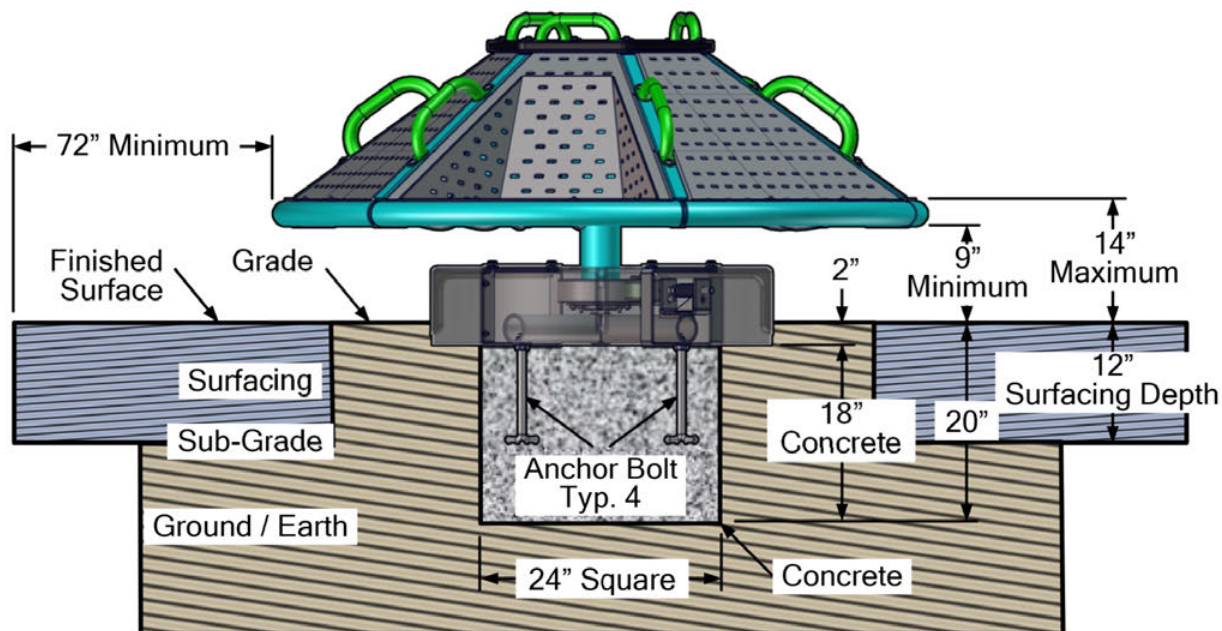

Concrete Forms and Framing Provided by Installer

Allow Concrete to Cure Based Upon Manufacturer's Specifications. Recommended Cure Time is 7 Days.

Concrete Required: 6.0 ft³ - 0.22 cubic yards

STEP 4

Slide platform base over center shaft of base assembly. Align holes in lower platform base plate with holes in base collar. Secure platform base to base assembly with four (4) 3/8" x 1-1/4" hex head bolts, four (4) 3/8" lock washer, and four (4) 3/8" hex nuts. See Details 4-1.

Detail 4-1

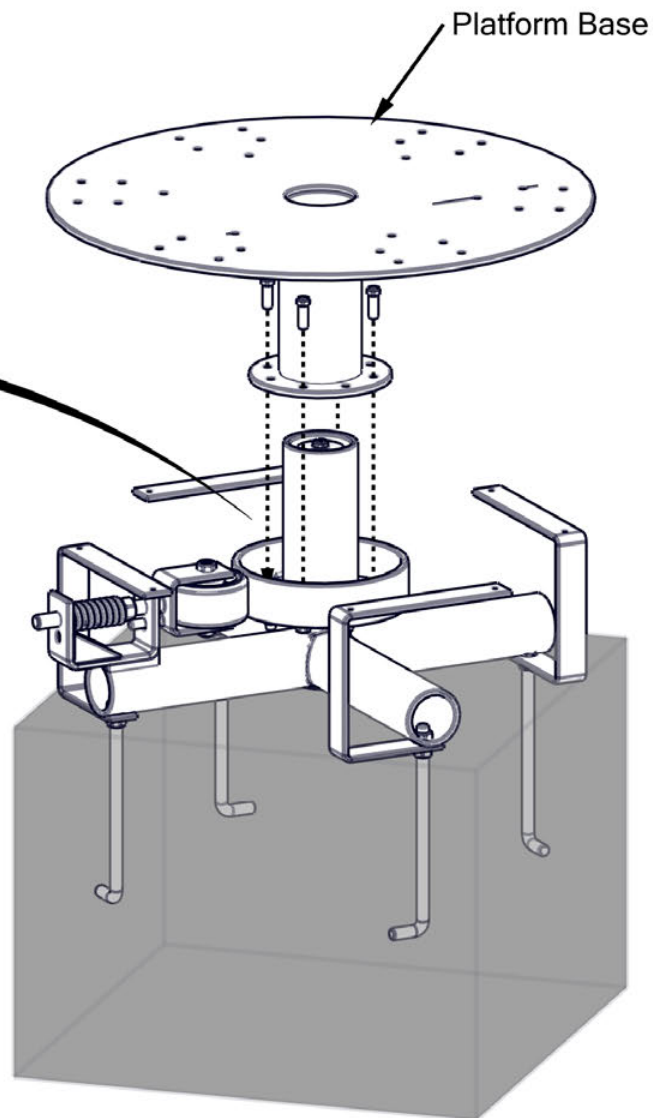
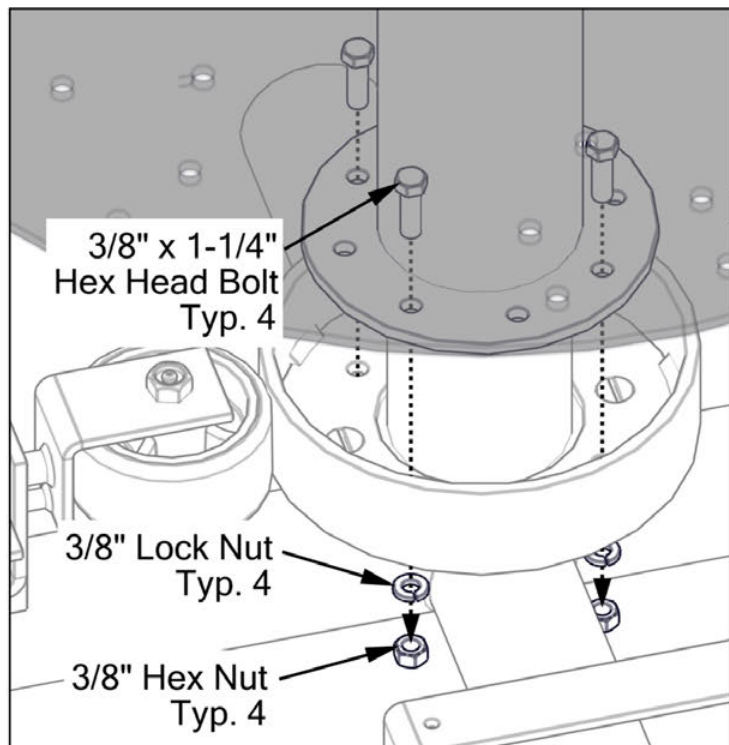

STEP 5

****ALL remaining hardware should be assembled loosely and NOT FULLY TIGHTENED.**** Hardware will be tightened after unit is fully assembled. Mount six (6) section support arms and three (3) alternated center cover plates to platform base. Align holes in arms and covers with holes in base plate. At each support arm square plate, insert four (4) 3/8" x 1-1/4" security Torx through four (4) 3/8" x 1" flat washers, through bottom of platform base, and through support arm square plate. One (1) bolt will also pass through end of cover plate. Secure with four (4) 3/8" x 1" flat washers and four (4) 3/8" Nylon lock nuts. See Detail 5-1. Repeat for all section support arms and center cover plates.

Detail 5-1

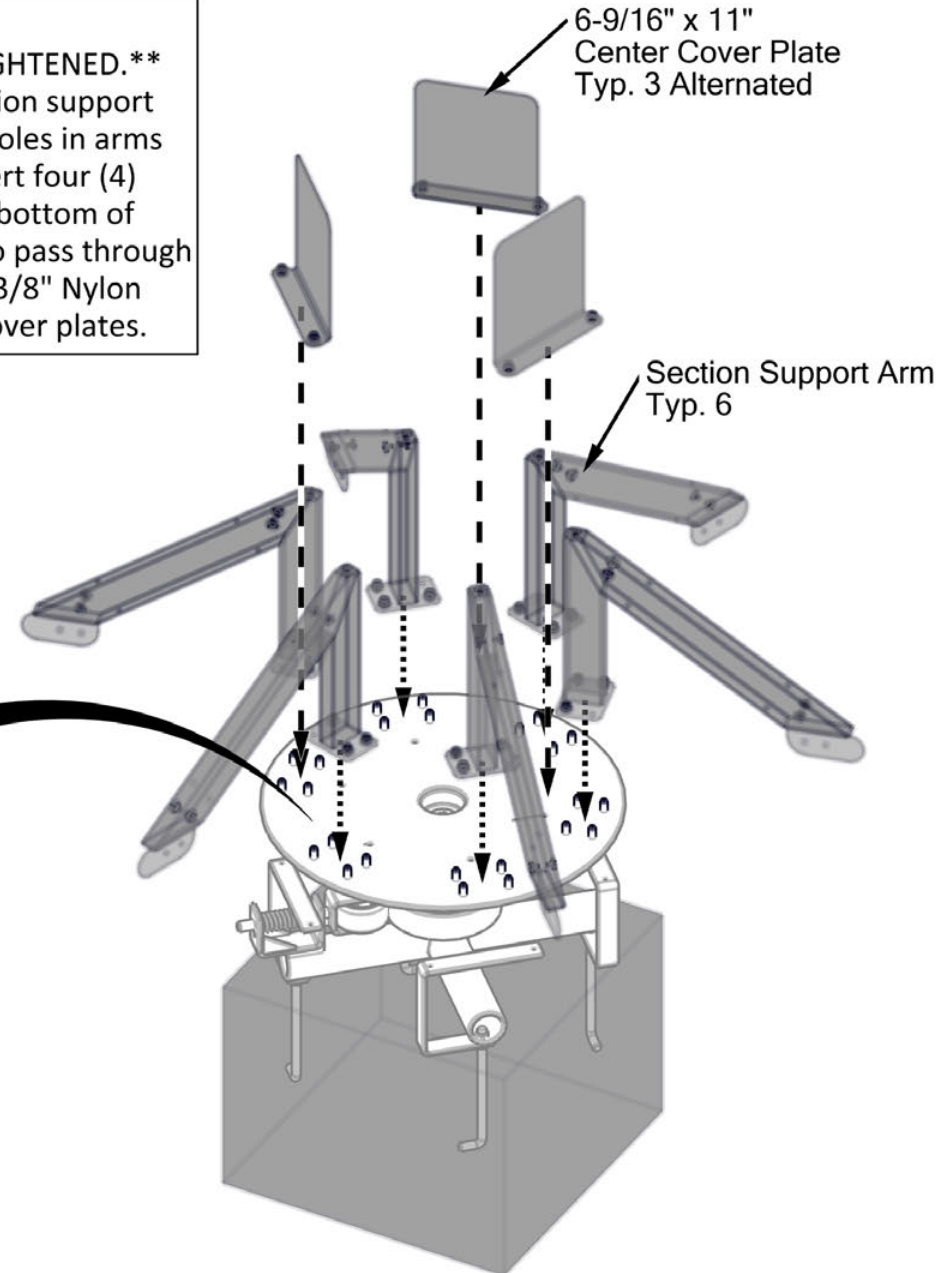
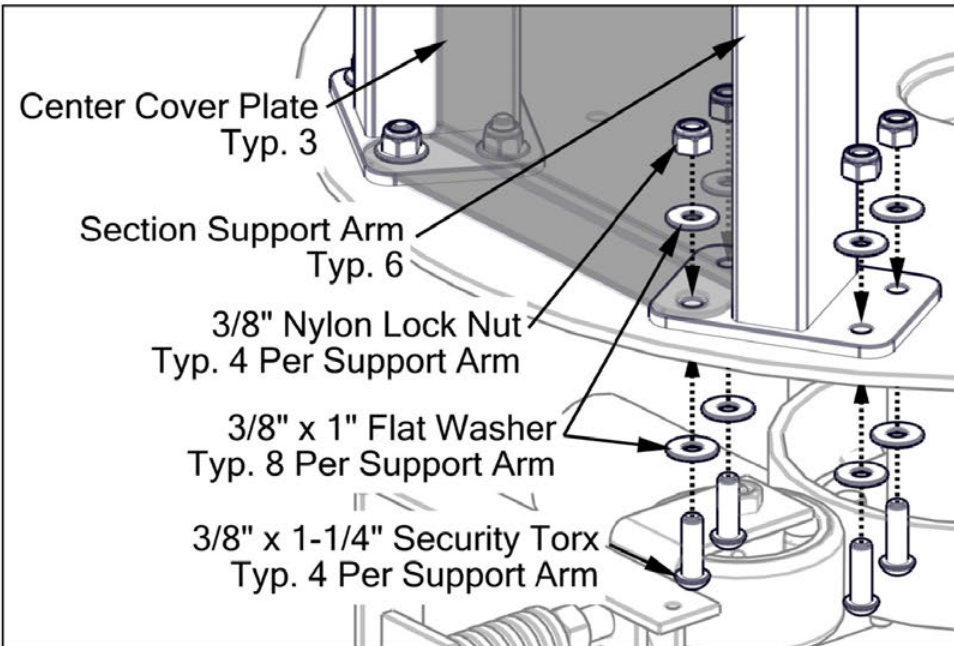

STEP 6

Mount six (6) support ring sections to tab plates on section support arms. Place one (1) support ring section on each side of one tab plate. Secure all together with two (2) 3/8" x 1-1/4" security Torx, four (4) 3/8" x 1" flat washers, and two (2) 3/8" Nylon lock nuts. See Detail 6-1. Repeat for remaining support ring sections and section support arms.

Detail 6-1

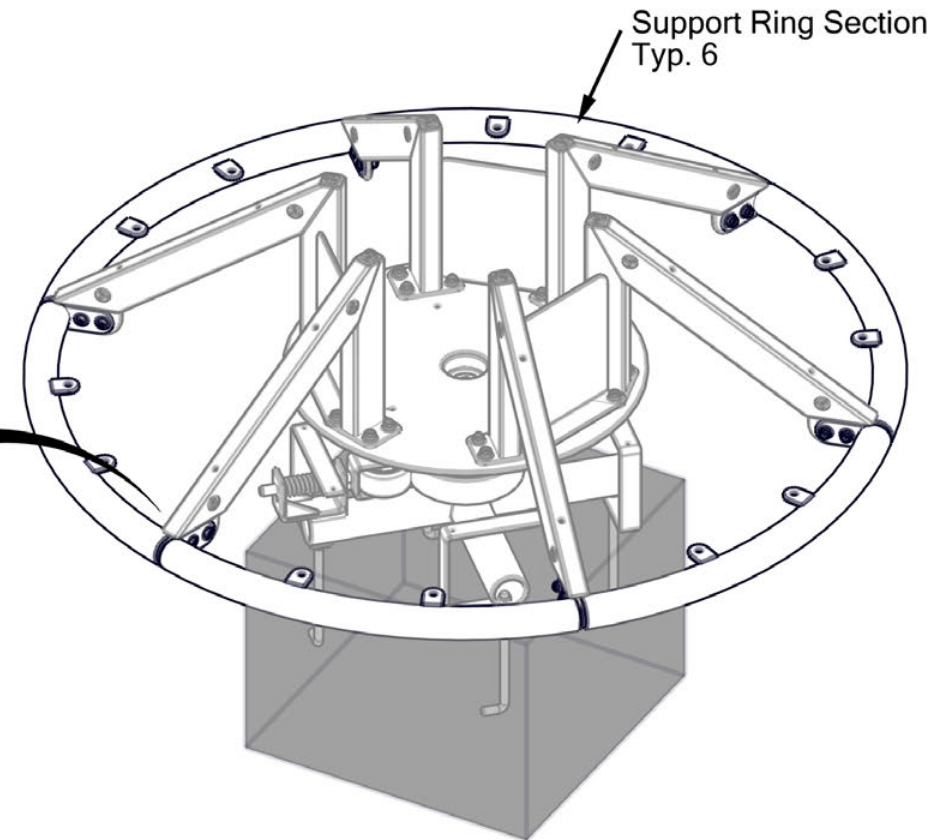
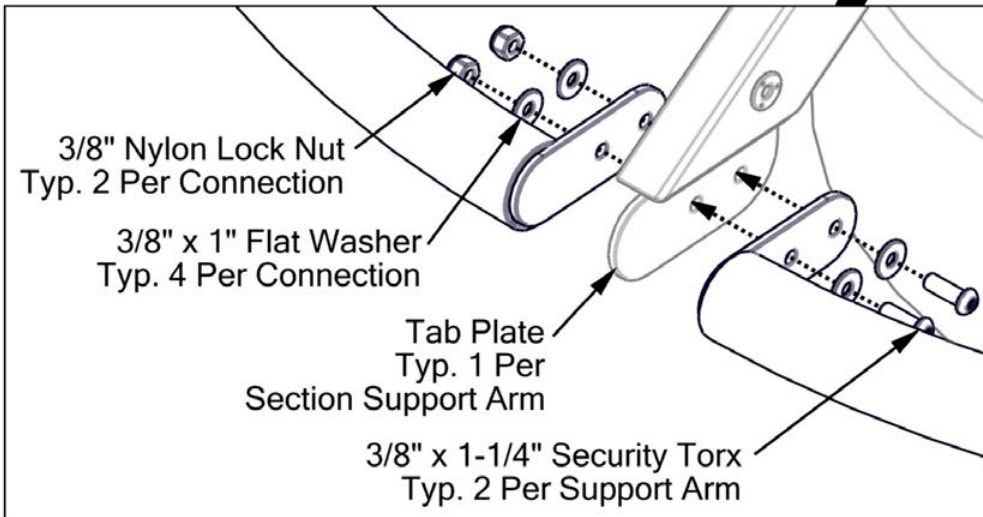

STEP 7

Mount six (6) 10" grab handles to section support arms. Place one (1) grab handle onto each section support arm. Secure grab handle to support arm with two (2) 3/8" x 3-3/4" security Torx, four (4) 3/8" x 1" flat washers, and two (2) 3/8" Nylon lock nuts. See Detail 7-1. Repeat for remaining 10" grab handles.

Detail 7-1

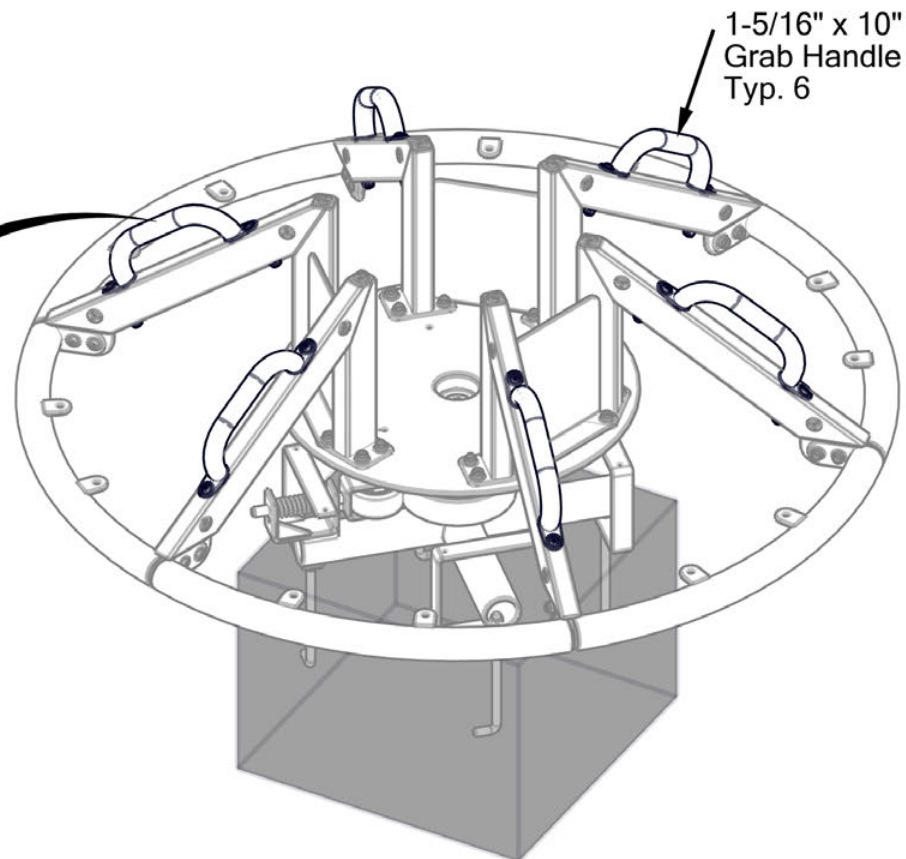
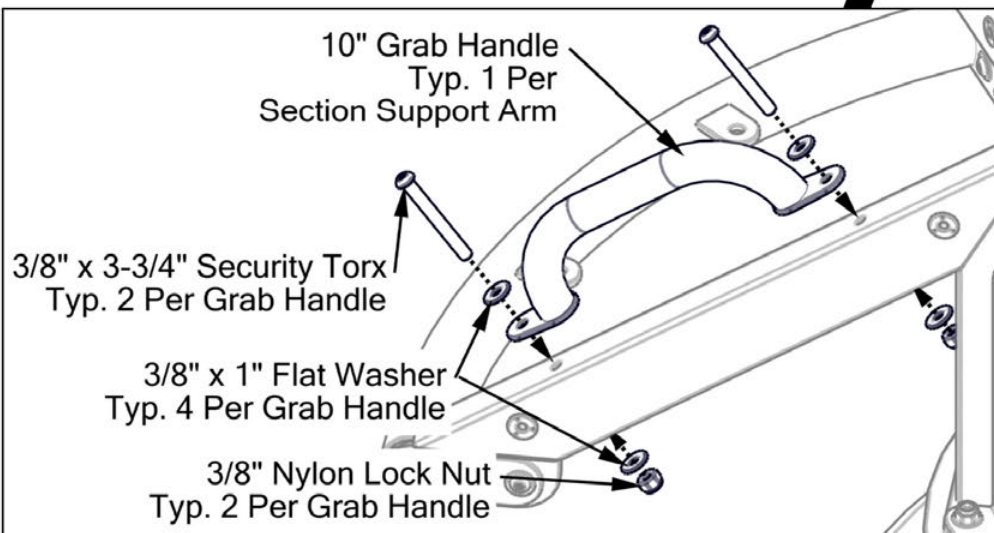

STEP 8

Mount round cover plate to platform base. Align holes in round cover plate with holes in top of platform base. Insert bolts from bottom of platform base and through cover plate. Secure with six (6) 3/8" x 1" security Torx, twelve (12) 3/8" x 1" flat washers, and six (6) 3/8" Nylon lock nuts.

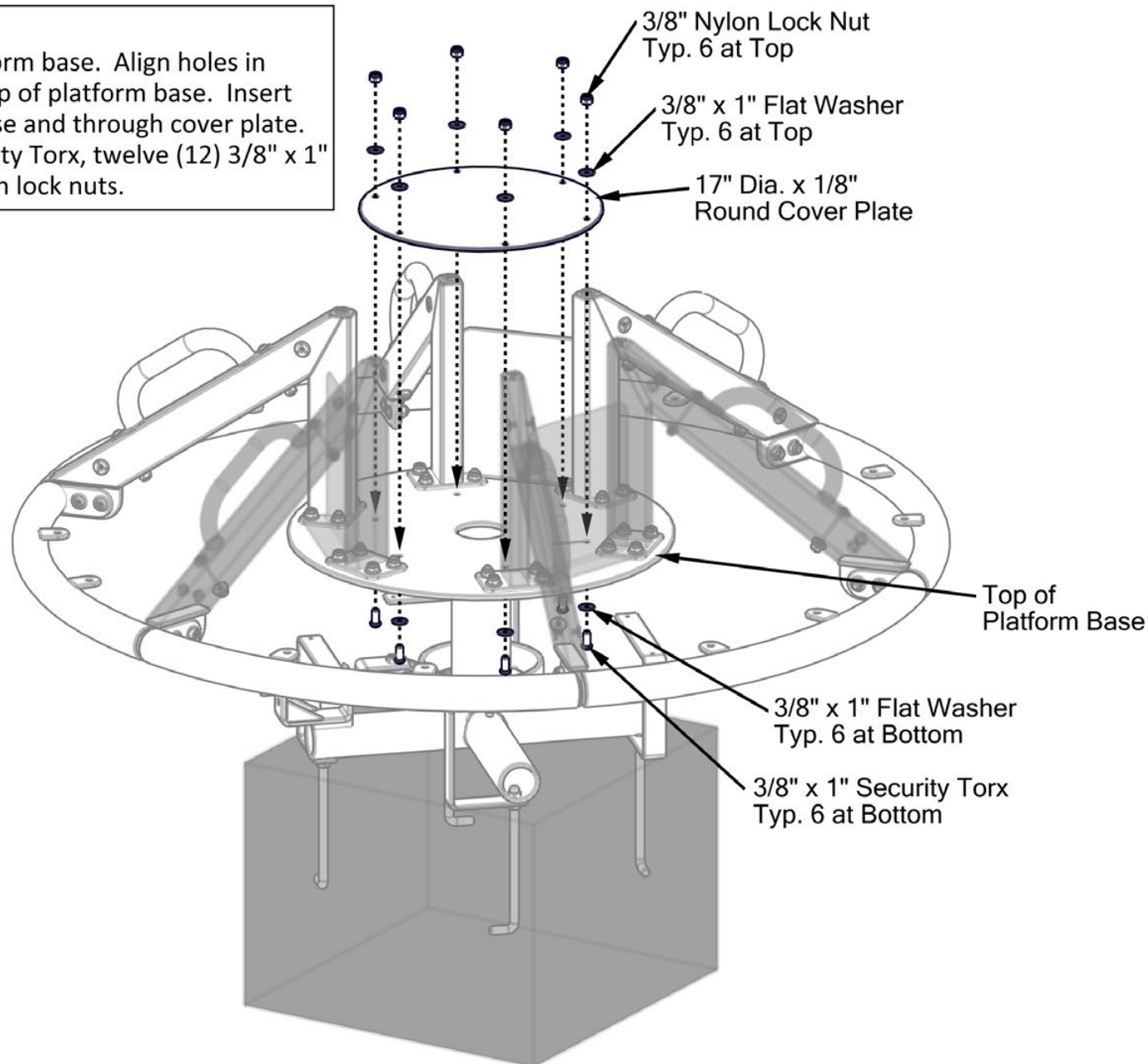

STEP 9

Start mounting hardware into all section support arms. Each section support arm requires four (4) 3/8" x 1" hex head bolts, four (4) 3/8" lock washers, and four (4) 3/8" x 1-1/4" flat washers. Place three (3) flat section panels onto mounting hardware in section support arms. Flat section panels **MUST BE MOUNTED** in same sections as center cover plates. Slide panel slots over hardware. Repeat for all flat section panels and center cover plates.

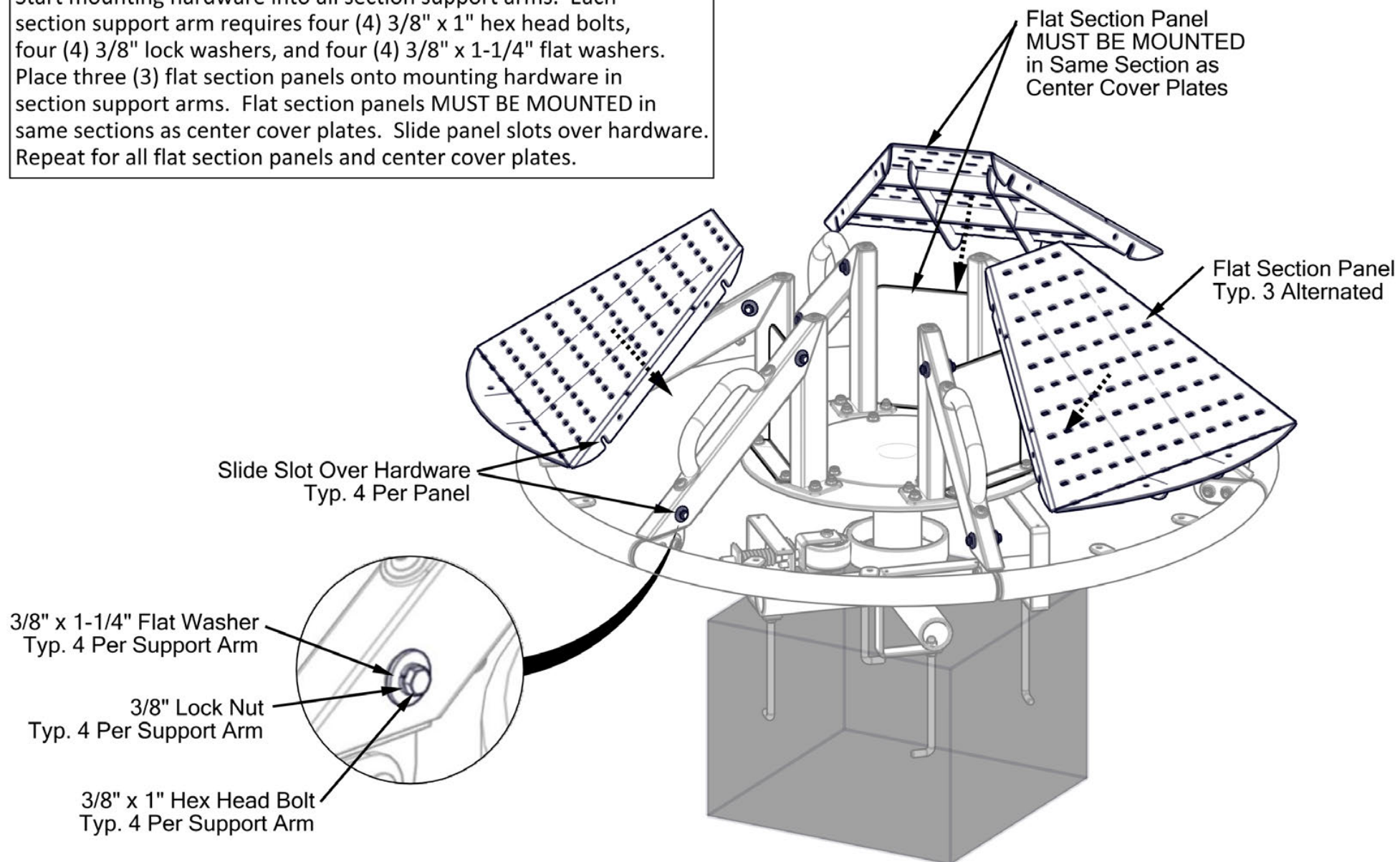

STEP 10

Place three (3) seat section panels onto mounting hardware in section support arms. Slide panel slots over hardware. Repeat for all seat section panels.

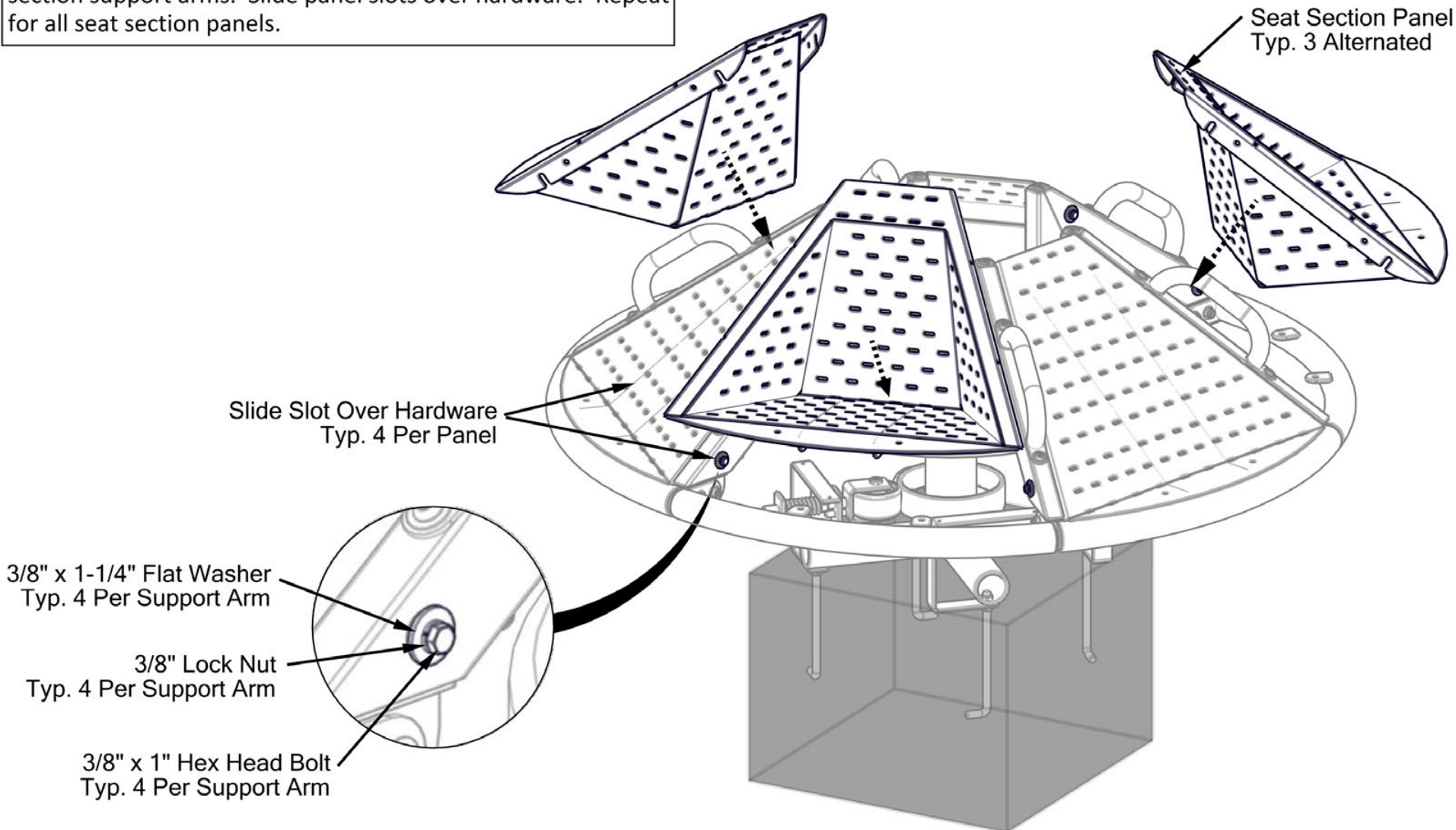

STEP 11

Secure all section panels to support ring section. Align holes in curved edge of each section panel with tabs on support ring section. Secure panel to ring with two (2) 3/8" x 1" security Torx, four (4) 3/8" x 1" flat washers, and two (2) 3/8" Nylon lock nuts. Repeat for all section panels.

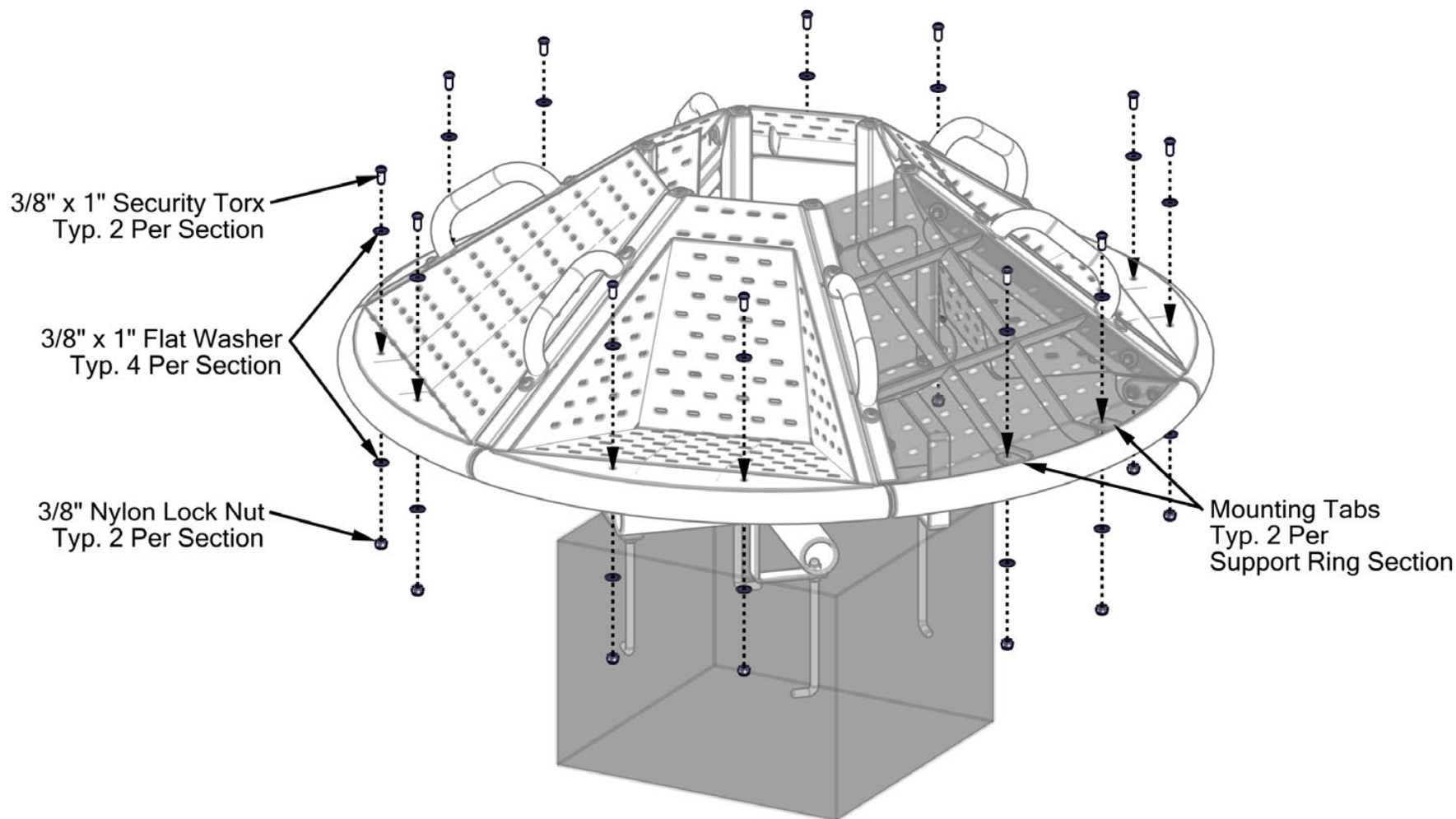

STEP 12

Assemble recessed center cover halves. Place halves together and align holes. Secure together with four (4) 3/8" x 1" security Torx, eight (8) 3/8" x 1" flat washers, and four (4) 3/8" Nylon lock nuts.

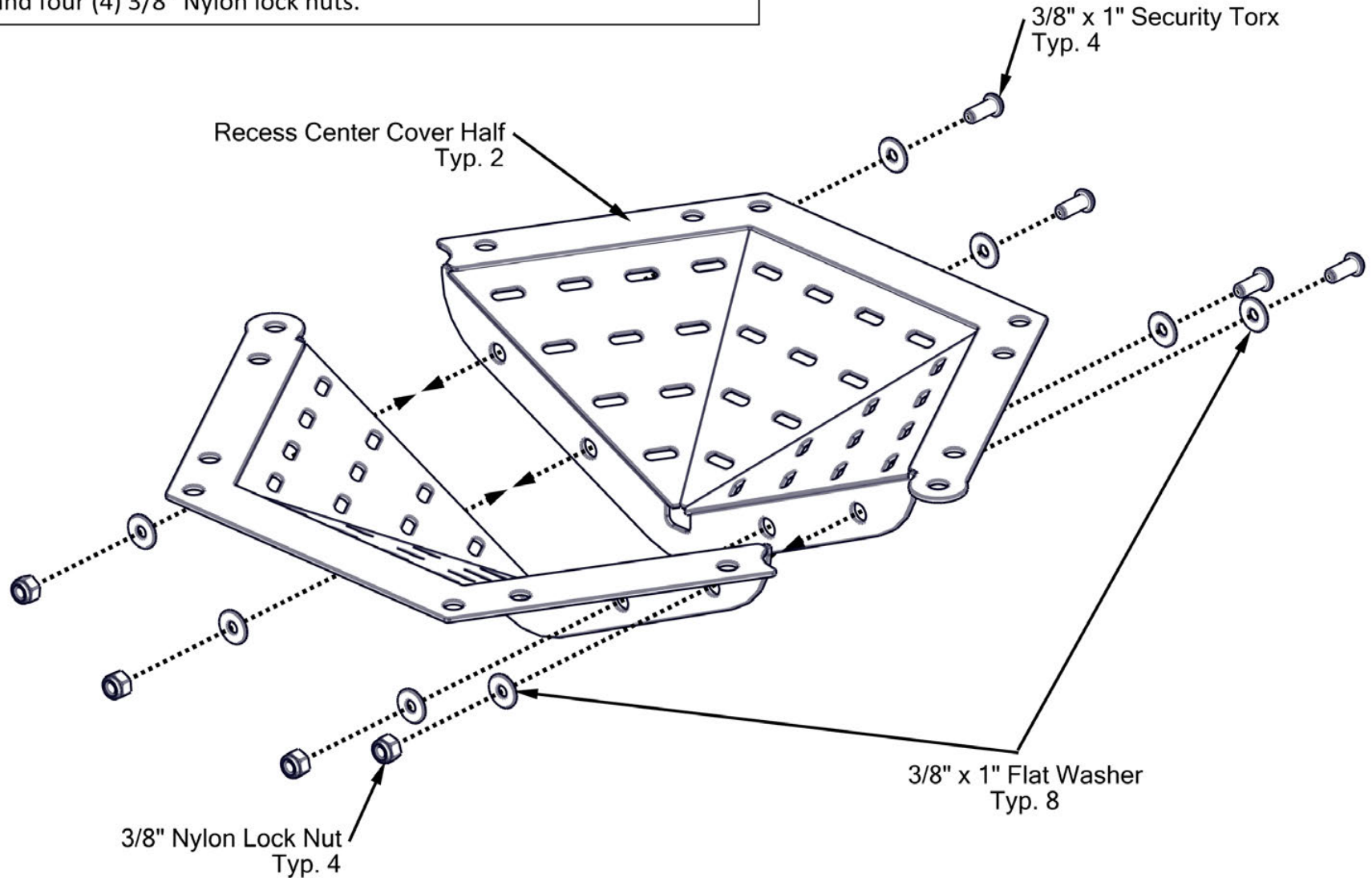

STEP 13

Place recessed center cover into top of unit. Align holes in cover with inserts in tops of section support arms. A ratchet strap, rope, or banding can be looped through all grab handles to tighten sections together and align holes in cover and arms. Place one (1) guard panel and three (3) 7-3/4" grab handles on top of recessed center cover. For each grab handle, secure grab handle through guard panel, through center cover, and into support arms with two (2) 3/8" x 1" flat washers and two (2) 3/8" x 2-1/2" security Torx. Repeat for all grab handles. **FULLY TIGHTEN ALL HARDWARE NOW.**

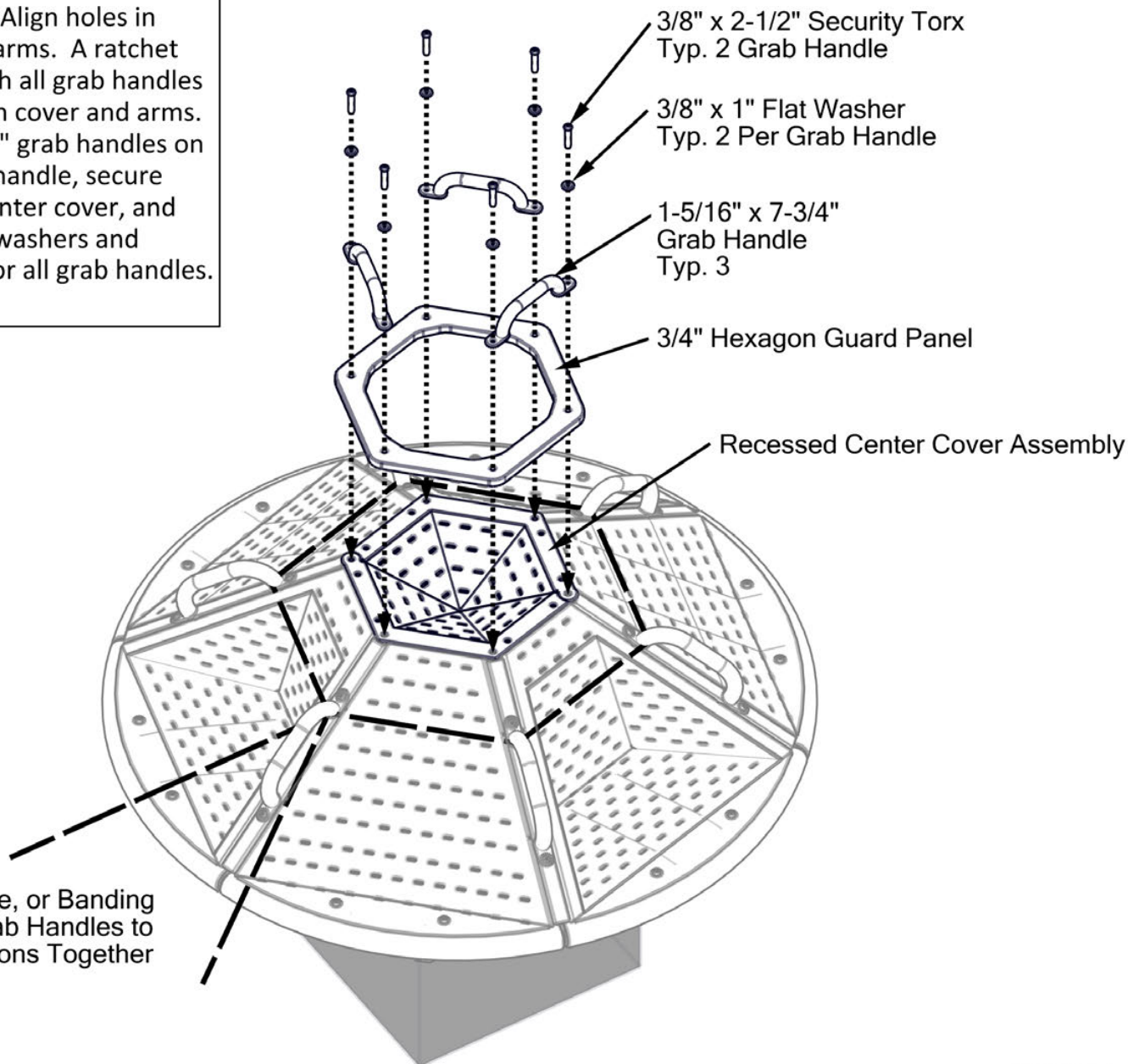

STEP 14

Rotation speed **MUST BE CHECKED AND ADJUSTED** based upon use zone.
Spin platform to maximum speed. Use watch to count rotations per minute (RPM).
Below platform, at brake assembly, rotate nut counterclockwise to loosen brake and increase RPM. Rotate nut clockwise to tighten brake and decrease speed.
See Detail 14-1. If Use Zone is 72" to 107", maximum speed must be set to 32 RPM.
If Use Zone is 108" or greater, maximum speed must be set to 45 RPM.

Detail 14-1

Rotate Nut Counterclockwise
to Loosen Brake
and Increase RPM

Rotate Nut Clockwise
to Tighten Brake
and Decrease RPM

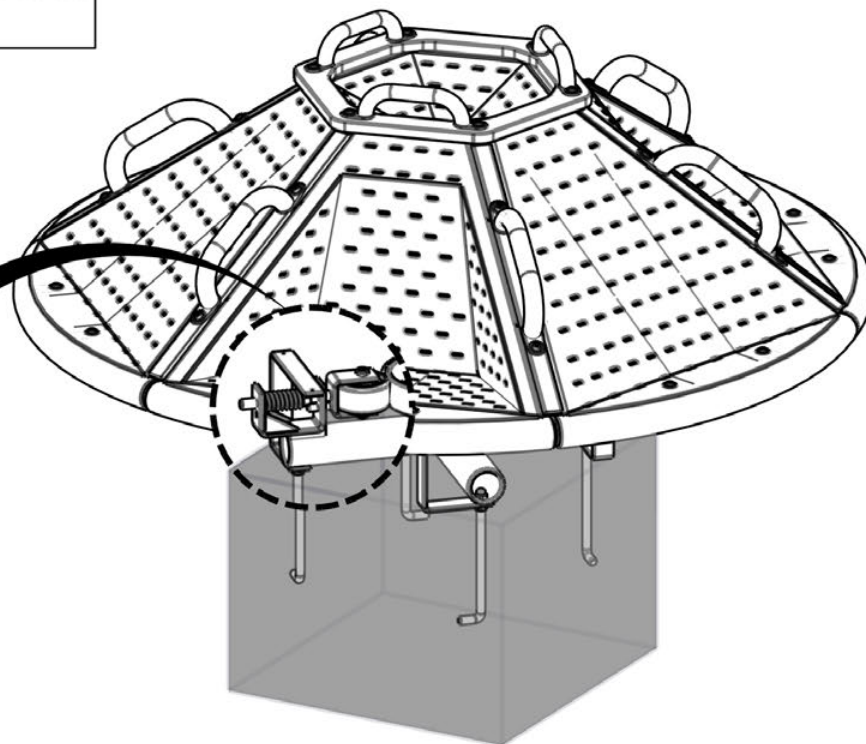
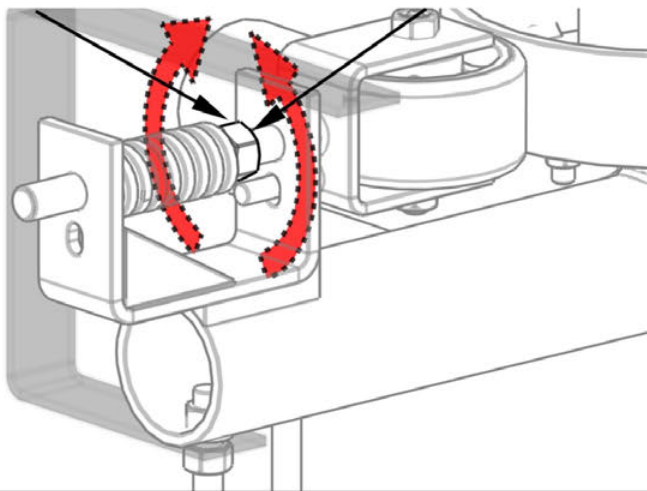

STEP 15

Place base shields around base assembly. Align holes in top of shield halves with holes in tops of shield mounting brackets. Loosen and retighten anchor bolt hardware as needed to align shield halves and brackets. Secure shield halves to shield mounting brackets with four (4) 3/8" x 1-1/4" flat washers and four (4) 3/8" x 1" self-tapping hex head bolts. See Detail 4-1. At overlap of shield halves, secure shield halves together with four (4) 1/4" x 5/8" flat washers and four (4) #10 x 5/8" pan head Phillips screws. See Detail 15-1. Check all connections and ensure structure is stable. All concrete must be fully cured before use of structure. Installation is complete. Place one (1) Age Appropriate Sticker on structure in a clearly visible location.

Detail 15-1

