

-  = INSTALLATION DETAIL
-  = PARTS LIST REFERENCE

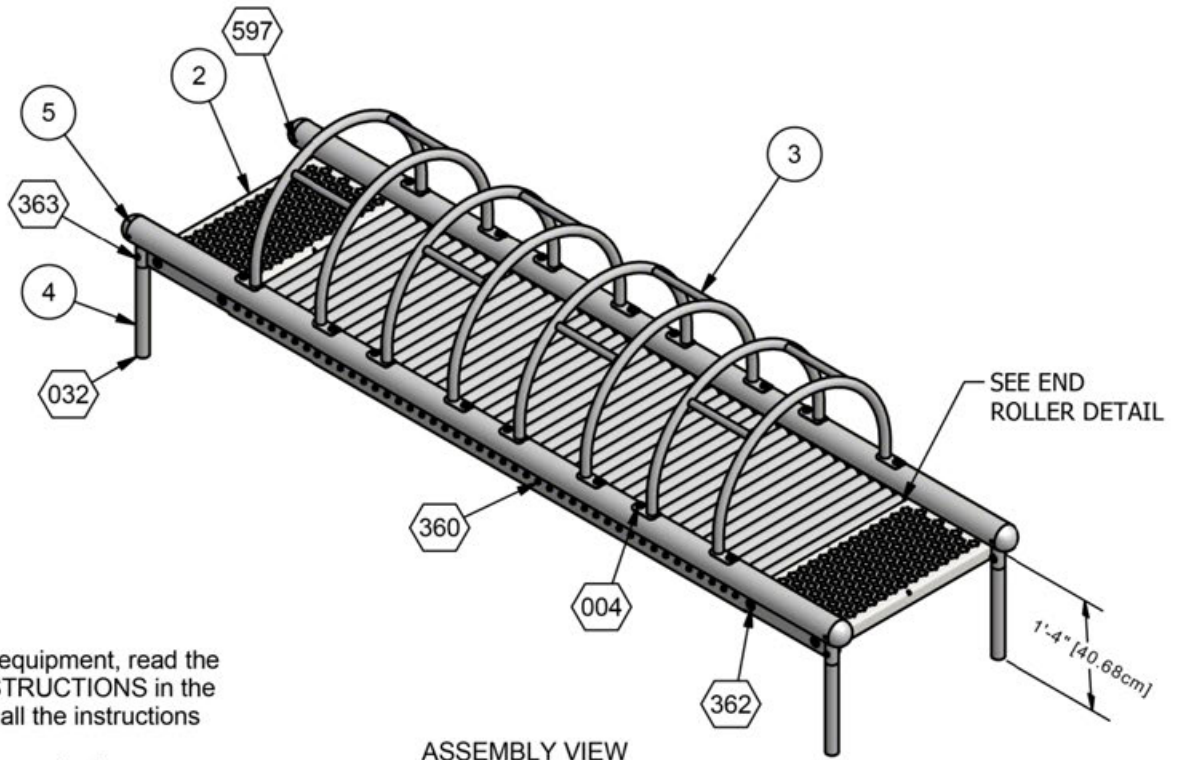

ASSEMBLY VIEW

INSTALLATION INSTRUCTIONS

1. Before assembling this equipment, read the enclosed INSTALLER INSTRUCTIONS in the installation booklet; follow all the instructions during installation.
2. Assemble parts as shown in the ASSEMBLY DRAWING. Refer to the assembly details for the specific hardware required in each connection.

PLATFORMS SHOULD BE PUSHED AGAINST ITS ADJACENT ROLLER TO REMOVE ANY GAP. FIRST ROLLERS ON EACH SIDE WILL NOT SPIN.

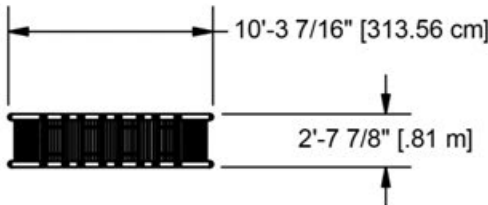

TOP VIEW

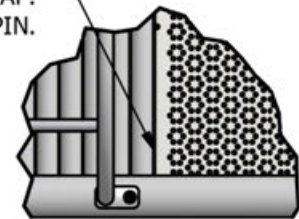

END ROLLER DETAIL

SPECIFICATIONS

ARCH HANDHOLD: The arch handhold shall be fabricated from rolled 1-5/16" O.D., 14 gauge (.083") wall galvanized steel tubing with connector rungs be manufactured from 1 1-1/16" O.D., 15 gauge (.075") wall galvanized steel tubing. Mounting tabs shall be 3/16" hot rolled steel. Shall be one-piece welded assemblies and shall be coated with a custom formula TGIC polyester powder coating.

SIDE RAIL: The side rails shall be fabricated from 3 1/2" O.D. (.125" wall) aluminum tubing with a factory installed dome cap. The bottom rail shall be 1/4" aluminum with laser cut holes to receive roller shafts. The socket shall be 1 1/4" (SCH 40) pipe to receive in-ground pipe. Side rails shall be one-piece welded assemblies coated with a custom formula TGIC polyester powder coating.

PLATFORM: The platforms shall be fabricated from 12 gauge steel. Shall consist of a welded assembly with an oven cured matte finish polyvinyl chloride (PVC) coating with a minimum coating thickness of .080".

ROLLER: The rollers shall be fabricated from 1.90" O.D. (16 ga wall) galvanized pipe coated with a custom formula TGIC beige powder coating.

SPECIFICATIONS (CONTINUED)

ROLLER BEARING: The roller bearing is a polypropylene housing with a precision steel ball bearing molded within. Each bearing has a 1011 lb load capacity.

ROLLER HEX AXLE SHAFT: The roller axle is fabricated from 7/16" Hexagonal stainless steel. Each end is drilled and tapped to receive hardware

IN-GROUND PIPE: The In-ground pipes are fabricated from 1 1/4" (SCH 40) aluminum pipe. Shall be coated with a custom formula TGIC polyester powder coating.

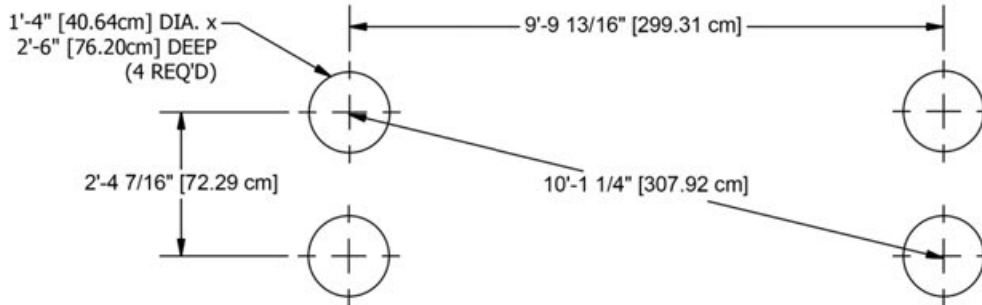

GROUND PLAN

NOTE: HOLE DEPTHS INDICATED ON ALL GROUND PLANS ARE MEASURED FROM THE FINISHED SURFACE. SEE DETAIL 032. ALL FOOTING DIMENSIONS ARE BASED ON LEVEL FINISHED SURFACE.

CONCRETE REQUIRED:

.24 CUBIC YARDS
[.20 CUBIC METERS]

Parts List		
DESCRIPTION	QTY	PART NUMBER
SIDE RAIL	2	207805
PLATFORM	2	208872
ARCH HANDHOLD	4	207791
IN-GROUND PIPE	4	208889
ROLLER	44	207771
HEX AXLE SHAFT	44	208890
BEARING	88	208462
3 1/2" DOME CAP	4	212995
HARDWARE COMPLETE	1	220666
3/16" x 13/32" DRIVE RIVET	8	805366
3/8" x 1 1/4" B.H.C.S.	24	811051
3/8" x 1 3/4" B.H.C.S.	4	811054
3/8" FLAT WASHER	16	817410
3/8" FLAT WASHER (1 1/4" O.D.)	16	817424
3/8" LOCK WASHER	28	817334
3/8" HEX NUT	8	804053
5/16" x 3/4" B.H.C.S.	88	811040
5/16" FLAT WASHER	88	817406
5/16" LOCK WASHER	88	817330
3/8" BARREL NUT	4	804804

Unless Otherwise Specified, All Units of Measure are Each
* Included in Hardware

Warning: During Installation, Hardware and Small Parts Are Choking Hazards for Young Children. Store Unused Parts Appropriately Until Assembly is Completed. Once Assembly is Complete, Remove Any Hardware and Unused Parts from Play Environment and Dispose / Store in a Secure Location.

Note: Thread Locking Solution (Supplied by Others) Should be Used on All Threaded Hardware.
Note: After Assembly is Complete, Peen Tee-Nuts and Flat Washers to Match Curvature of Pipe / Post.

**** IMPORTANT ****

To Reduce the Risk of Clothing Entanglement in Compliance with ASTM F1487, Any Bolt End Protruding More Than Two Full Threads Beyond Face of Nut Must Be Cut Off Flush, Filed Smooth, and Treated to Prevent Corrosion.

Note: Thread Locking Solution (Supplied by Others) Should be Used on All Threaded Hardware.

Note: After Assembly is Complete, Peen Tee-Nuts and Flat Washers to Match Curvature of Pipe / Post.

Details

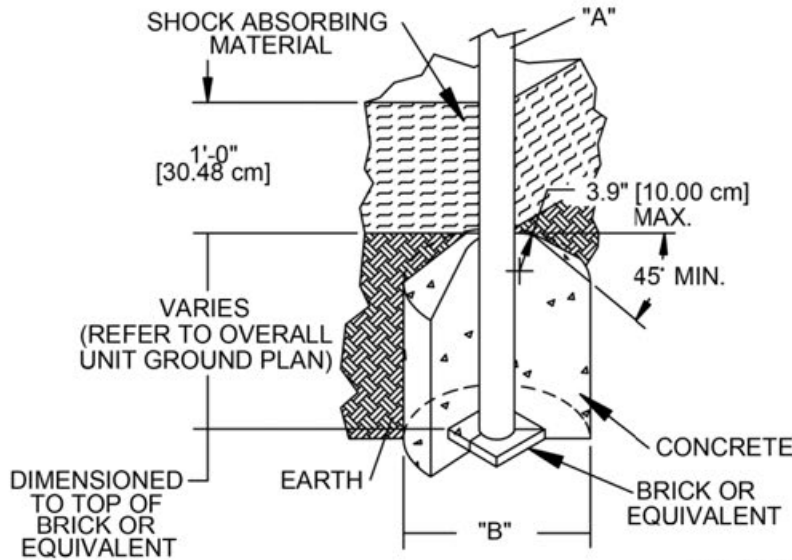

DIA. "A" (PIPE SIZE)	DIA. "B" (FOOTING SIZE)
1 1/16" [2.70 cm]	1'-2" [35.56 cm]
1 5/16" [3.33 cm]	1'-2" [35.56 cm]
1 5/8" [4.13 cm]	1'-2" [35.56 cm]
1 7/8" [4.83 cm]	1'-2" [35.56 cm]
2 3/8" [6.03 cm]	1'-2" [35.56 cm]
3 1/2" [8.89 cm]	1'-6" [45.72 cm]
5" [12.70 cm]	1'-6" [45.72cm]
TRACK RIDE & SWINGS	
5" [12.70 cm]	2'-0" [60.96 cm]
TREE SCAPE	
5" [12.70 cm]	4'-0" [121.92 cm]

NOTES:

- SLOPED FOOTING IS A REQUIREMENT OF EUROPEAN STANDARD EN1176-1 ONLY
- SUGGESTED MINIMUM CONCRETE RATING: 3000 PSI



SHOCK ABSORBING PROPERTIES OF SURFACING MATERIALS VARY. IF YOU DETERMINE THAT LESS THAN 1'-0" [30.48cm] OF SURFACING IS REQUIRED, MAKE UP THE DIFFERENCE IN ELEVATION WITH EARTH, BEFORE APPLYING SURFACING.

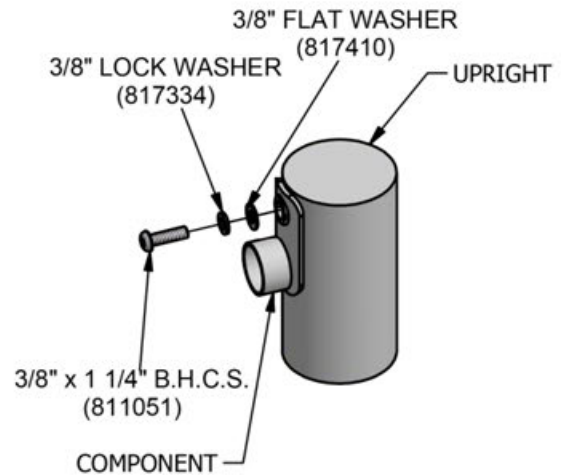
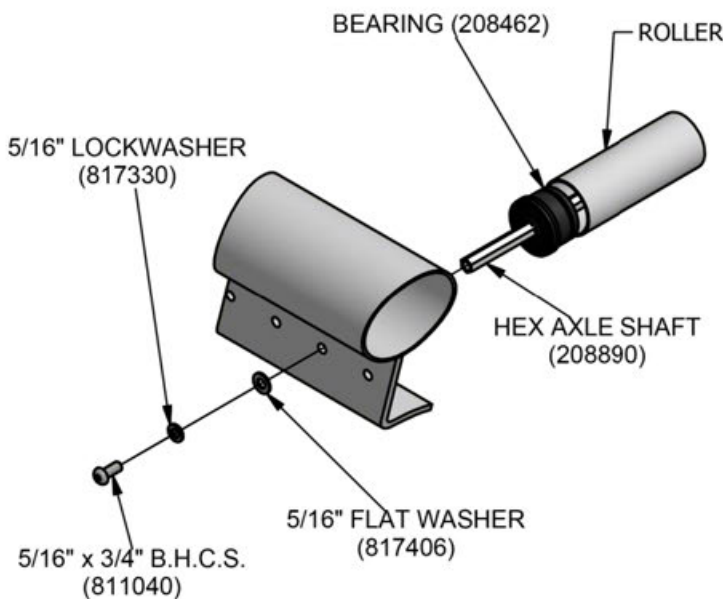

**** IMPORTANT ****

To Reduce the Risk of Clothing Entanglement in Compliance with ASTM F1487, Any Bolt End Protruding More Than Two Full Threads Beyond Face of Nut Must Be Cut Off Flush, Filed Smooth, and Treated to Prevent Corrosion.

Note: Thread Locking Solution (Supplied by Others) Should be Used on All Threaded Hardware.

Note: After Assembly is Complete, Peen Tee-Nuts and Flat Washers to Match Curvature of Pipe / Post.

Details

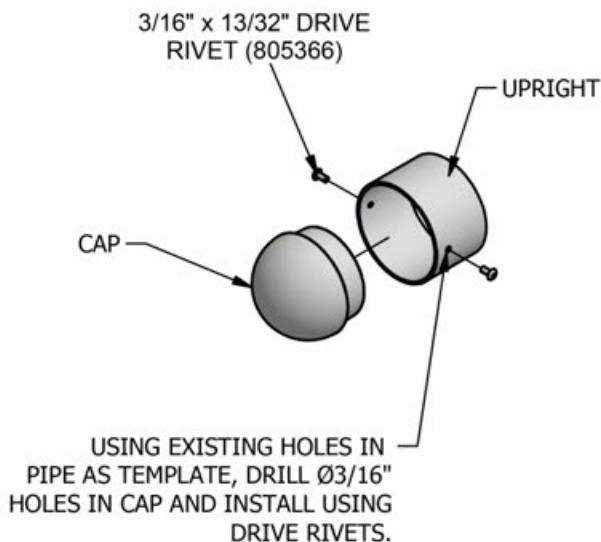
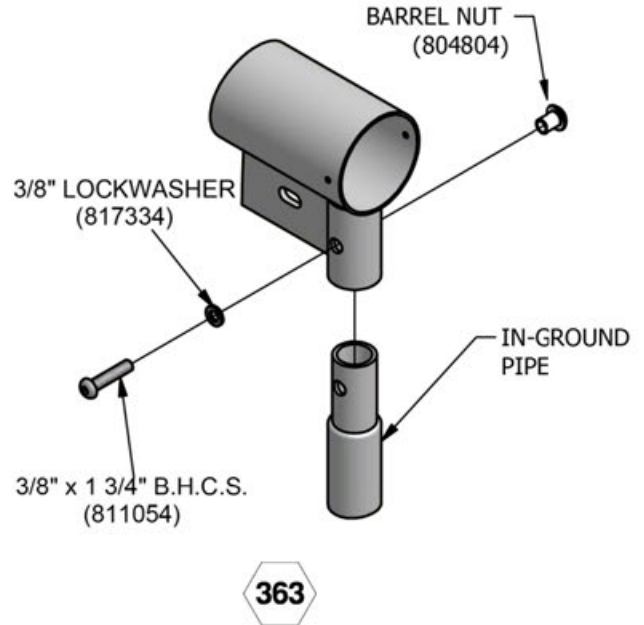
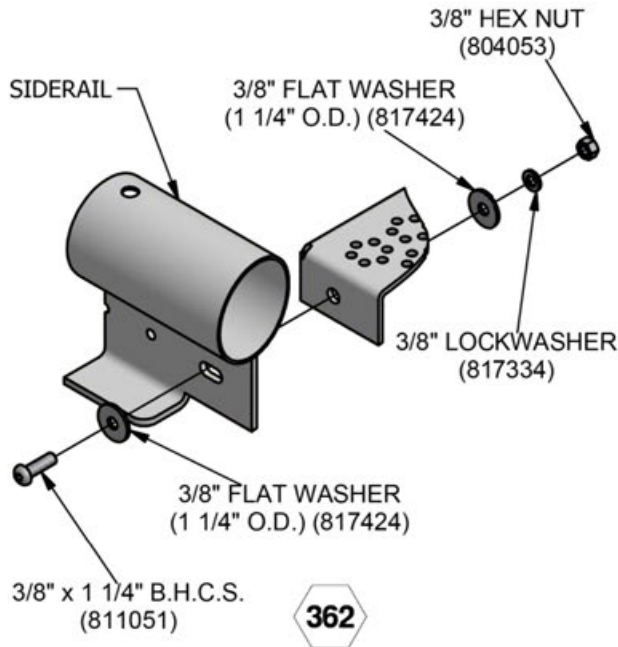

597

**** IMPORTANT ****

To Reduce the Risk of Clothing Entanglement in Compliance with ASTM F1487, Any Bolt End Protruding More Than Two Full Threads Beyond Face of Nut Must Be Cut Off Flush, Filed Smooth, and Treated to Prevent Corrosion.

Note: Thread Locking Solution (Supplied by Others) Should be Used on All Threaded Hardware.

Note: After Assembly is Complete, Peen Tee-Nuts and Flat Washers to Match Curvature of Pipe / Post.

NOTE:

OWNER/OPERATOR SHALL INSTALL AND MAINTAIN PROTECTIVE SURFACING WITH THE USE ZONE (U.S.) OR PROTECTIVE SURFACING ZONE (CANADA) OF ALL PLAY EQUIPMENT TO COMPLY WITH ASTM F-1487 (U.S.) OR CAN/CSA-Z-614 (CANADA).

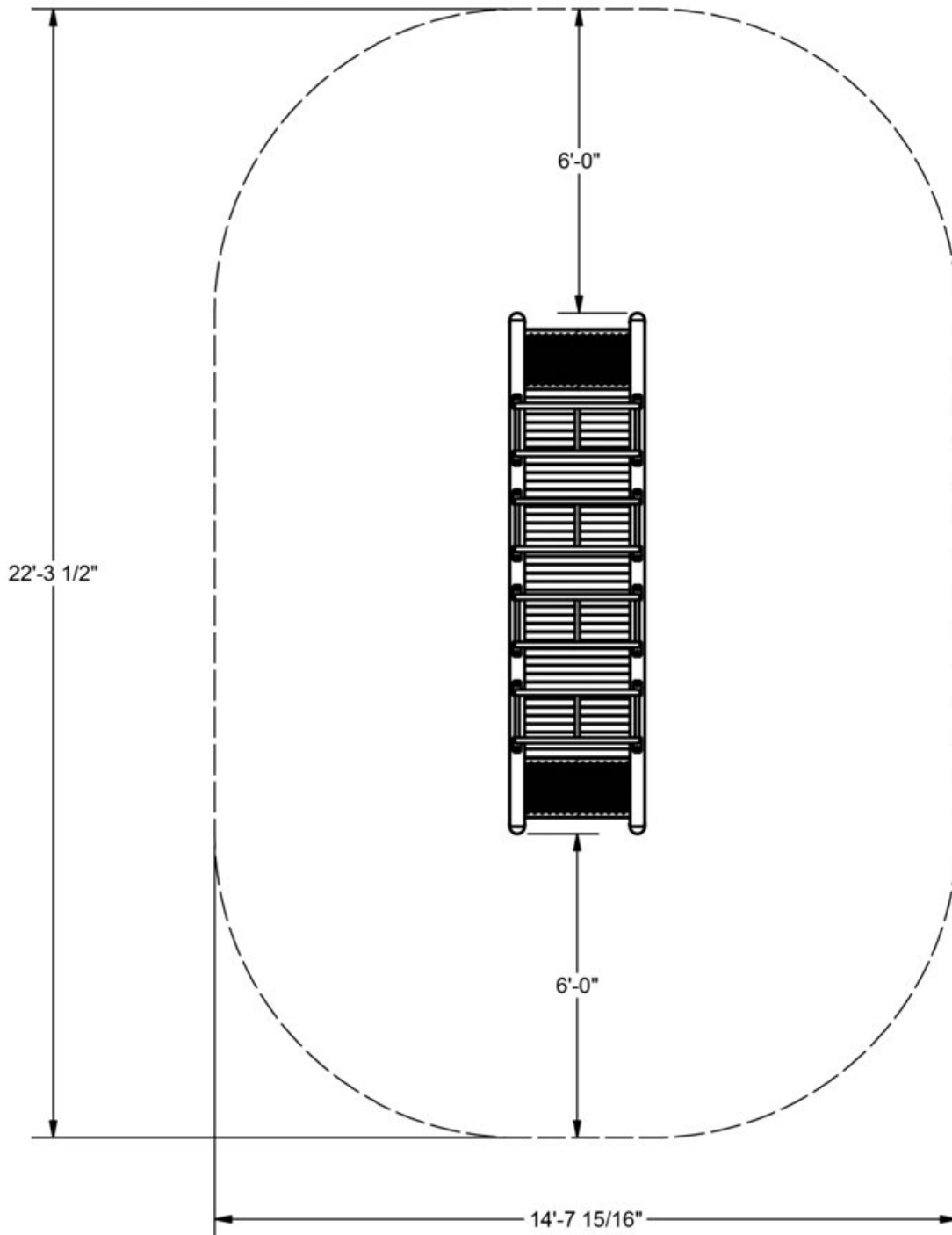

Page Intentionally Left Blank